

  
**MAP OF**
  
**TOWNSHIP 146 N., RANGE 69 W.**
  
*of the 5th P. M.*
  
 Scale 1 1/4 inches to 1 mile

|   |  |  |  |  |  |
|---|--|--|--|--|--|
| 3794<br>4<br>A.C. Sanford<br>6<br>360             | 3838<br>3<br>Moses Henry<br>Mummet Balte<br>80 80<br>5<br>John G. O.H.<br>Fredlund Travis<br>160 160 | 3882<br>2<br>E.A. Williams<br>4<br>Geo Whitton<br>3<br>480         | 3926<br>1<br>Cath Griffiths<br>2<br>Anna Davis           | 3970<br>2<br>W.J. Reed<br>1<br>240                 | 4014<br>1<br>F.L. Pinn<br>240                            |
| 3765<br>1<br>H.B. Jackson<br>7<br>240             | 3819<br>1<br>A.C. Sanford<br>160   | 3863<br>1<br>A.A. Wells<br>9<br>320                                | 3907<br>1<br>Mary Fergusson<br>160                       | 3951<br>1<br>Ella Ellsworth<br>160                 | 3995<br>1<br>Wheelock Anna<br>160 160                    |
| 3736<br>3<br>Dora & Sophia<br>Hinkeldt<br>240     | 3780<br>3<br>Chas. E. Gibson<br>(H. Colier Cont.)<br>160   | 3824<br>3<br>Warren & Preston<br>320                               | 3868<br>3<br>R. Wikey<br>160                             | 3912<br>3<br>Wheelock<br>Fred Richter<br>Cont. 160 | 3956<br>3<br>G.W. Herman<br>Doolittle Havens<br>160 160  |
| 3707<br>1<br>G.W. Grinneld<br>J. Holt<br>Cont. 80 | 3751<br>1<br>M.L. Chambers<br>320  | 3795<br>1<br>School Land<br>320                                    | 3839<br>1<br>Mrs. Emma Heyertz<br>M. Martin<br>Cont. 160 | 3883<br>1<br>Geo. J. Ross<br>160                   | 3927<br>1<br>George Maxwell<br>160                       |
| 3678<br>3<br>St. Jacques<br>P                     | 3722<br>3<br>Robt. P. Williams<br>320  | 3766<br>3<br>Fred Gusseck<br>320                                   | 3810<br>3<br>Wm. J. Johnston<br>160                      | 3854<br>3<br>Moses Martin<br>160                   | 3898<br>3<br>C.J. Schmitt<br>160                         |
| 3649<br>1<br>Saml. Johnson<br>90                  | 3704<br>1<br>Cath Mathews<br>320   | 3748<br>1<br>School<br>Warren Preston<br>Joseph Epple<br>Cont. 480 | 3792<br>1<br>Robt. Griffith<br>320                       | 3836<br>1<br>C.J. Schmitt<br>320                   | 3880<br>1<br>Mrs. L.C. Connor<br>160                     |
| 3620<br>3<br>John M. Winger<br>240                | 3664<br>3<br>Anthony McGinn<br>160   | 3708<br>3<br>Richard Sykes<br>160                                  | 3752<br>3<br>Robt. Griffith<br>320                       | 3796<br>3<br>C.J. Schmitt<br>320                   | 3840<br>3<br>Robt. Schultz<br>160                        |
| 3591<br>1<br>T.J. Harding<br>400                  | 3635<br>1<br>Richard Sykes<br>320  | 3679<br>1<br>Margt Griffith<br>160                                 | 3723<br>1<br>R. Griffith<br>Cont. 160                    | 3767<br>1<br>C.J. Schmitt<br>160                   | 3811<br>1<br>Northwestern Land Co.<br>160                |
| 3562<br>3<br>Henry St. Jacques<br>40              | 3606<br>3<br>Jas. Leigh<br>(O.M. Eaton Cont.)<br>320   | 3650<br>3<br>Robt. Maxwell<br>320                                  | 3694<br>3<br>M.W. Fletcher<br>160                        | 3738<br>3<br>G. Lewis<br>160                       | 3782<br>3<br>Schmidt<br>160                              |
| 3533<br>1<br>E.B. Murphy<br>80                    | 3577<br>1<br>Mary E. St. Jacques<br>160  | 3621<br>1<br>Joseph Lessner<br>160                                 | 3665<br>1<br>Geo. Edwards<br>(Nick Winandy)<br>Cont. 320 | 3709<br>1<br>G. Lewis<br>160                       | 3753<br>1<br>Paul<br>160                                 |
| 3504<br>3<br>Richard Sykes<br>80                  | 3548<br>3<br>I. St. Jacques<br>120   | 3592<br>3<br>Griffith Lewis<br>160                                 | 3636<br>3<br>Geo. Frater<br>160                          | 3680<br>3<br>Adolph Kutz<br>160                    | 3724<br>3<br>D.C. Gilliland<br>(Wm. Hammas)<br>Cont. 160 |
| 3475<br>1<br>G.V. Cunningham<br>320               | 3519<br>1<br>Marshall Brinton<br>320   | 3563<br>1<br>Wheeler<br>320  | 3607<br>1<br>P.F. Mathews<br>320                         | 3651<br>1<br>Julius Klinger<br>160                 | 3695<br>1<br>Wm. Boehlke<br>320                          |
| 3446<br>3<br>Richard Sykes<br>80                  | 3490<br>3<br>Wheeler<br>320  | 3534<br>3<br>School Land<br>160                                    | 3578<br>3<br>F. Hildebrand<br>Cont. 160                  | 3622<br>3<br>School Land<br>160                    |  |

  
**MAP OF**
  
**TOWNSHIP 146 N., RANGE 70 W.**
  
*of the 5th P. M.*
  
 Scale 1 1/4 inches to 1 mile

### SPEEDWELL TOWNSHIP

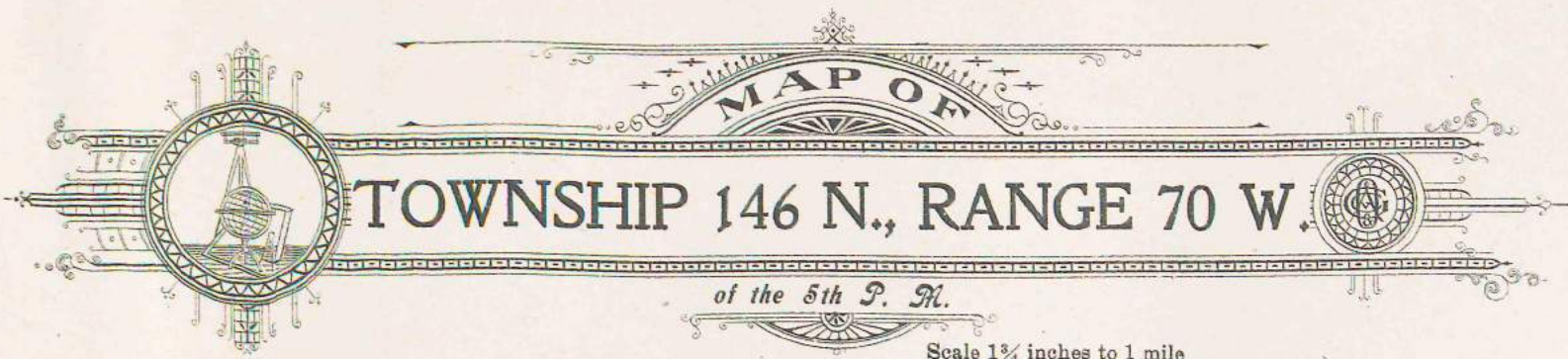
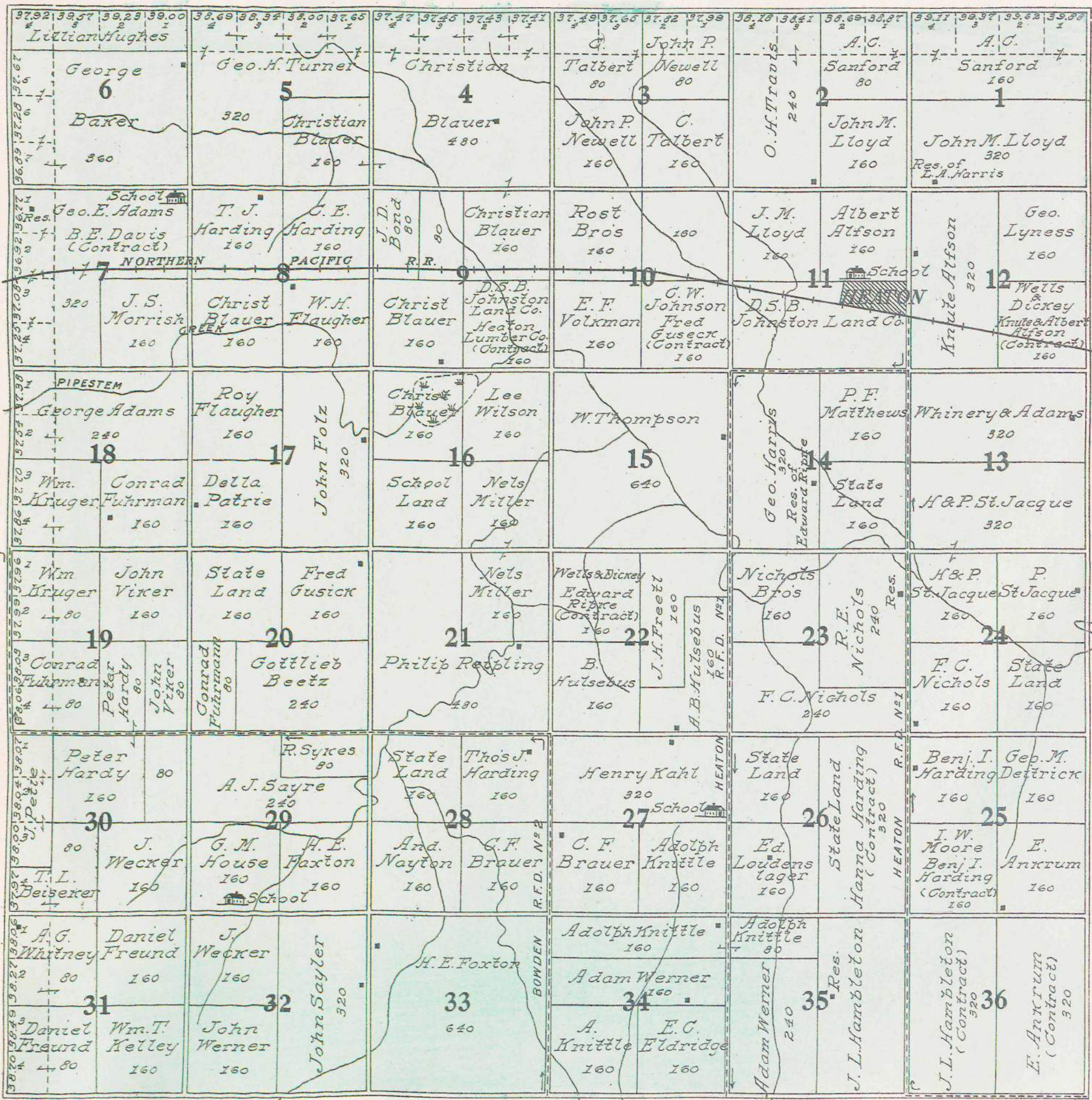

MAP OF  
TOWNSHIP 146 N., RANGE 71 W.  
of the 5th P. M.  
Scale 1 1/4 inches to 1 mile

