

MAP OF
TOWNSHIP 158 N., RANGE 93 W.
 OF THE 5th P. M.

Scale 1 3/4 inches to 1 mile

POWERS LAKE

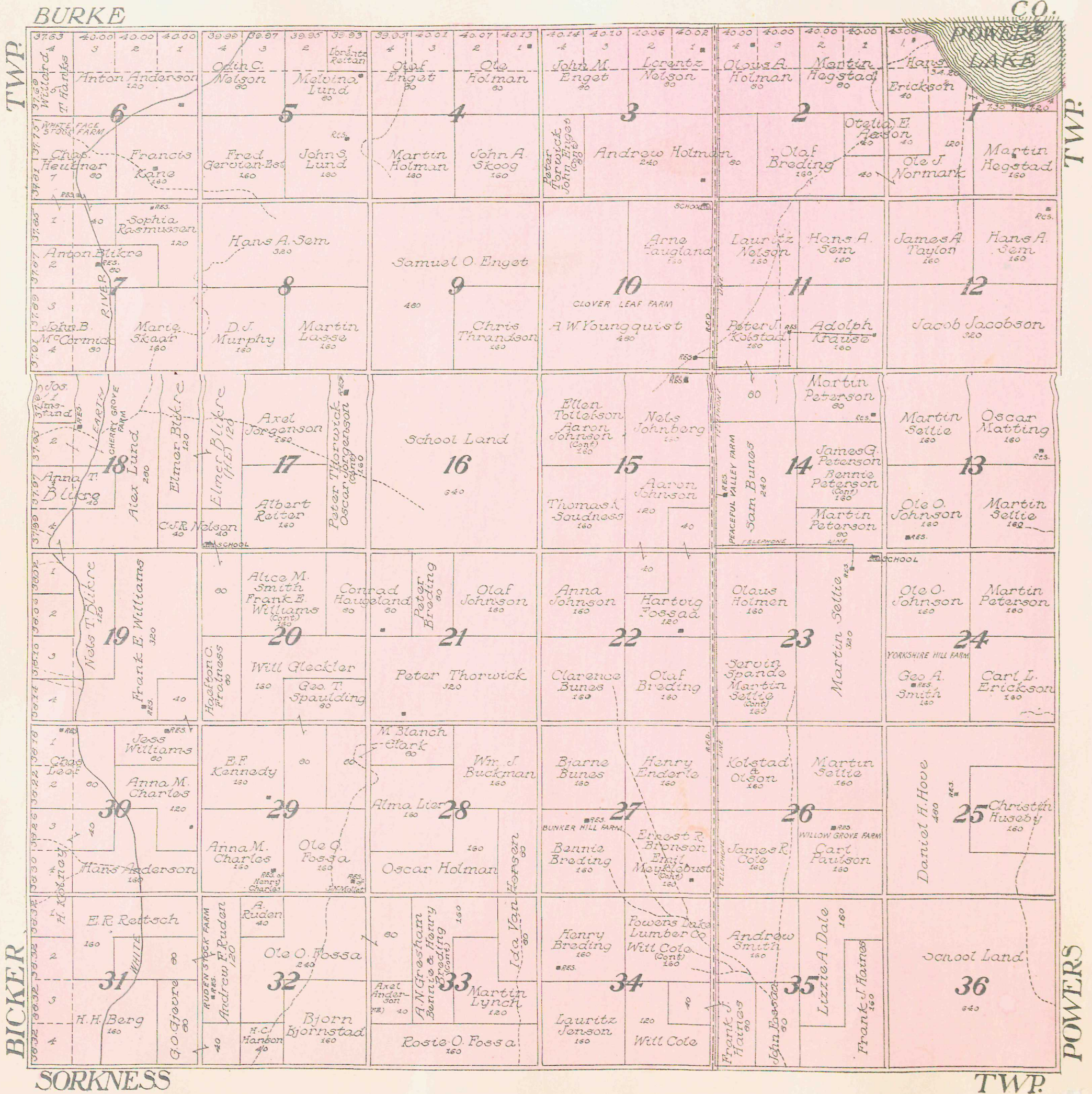

POWERS

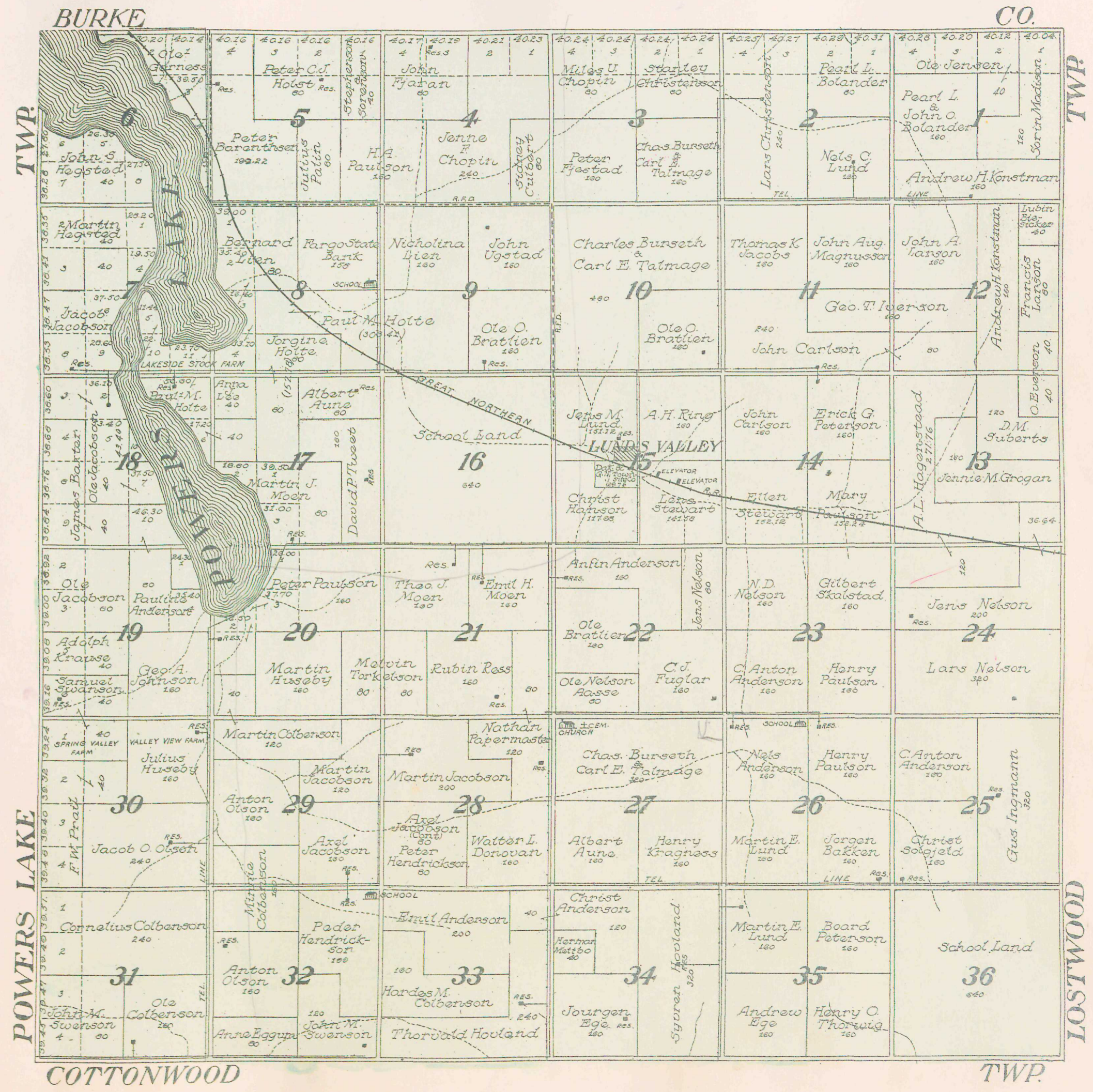

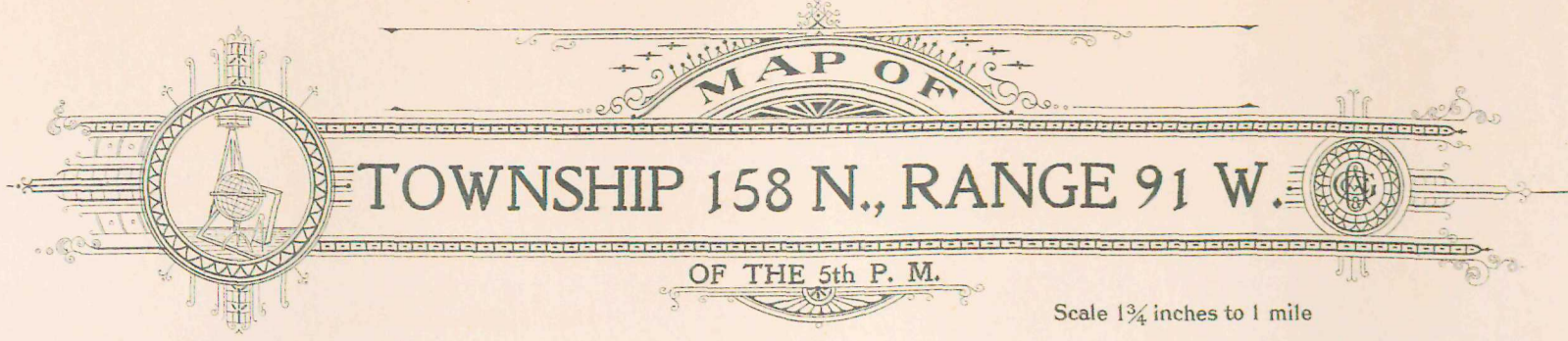

MAP OF
TOWNSHIP 158 N., RANGE 91 W.
 OF THE 5th P. M.

Scale 1 1/4 inches to 1 mile

LOSTWOOD

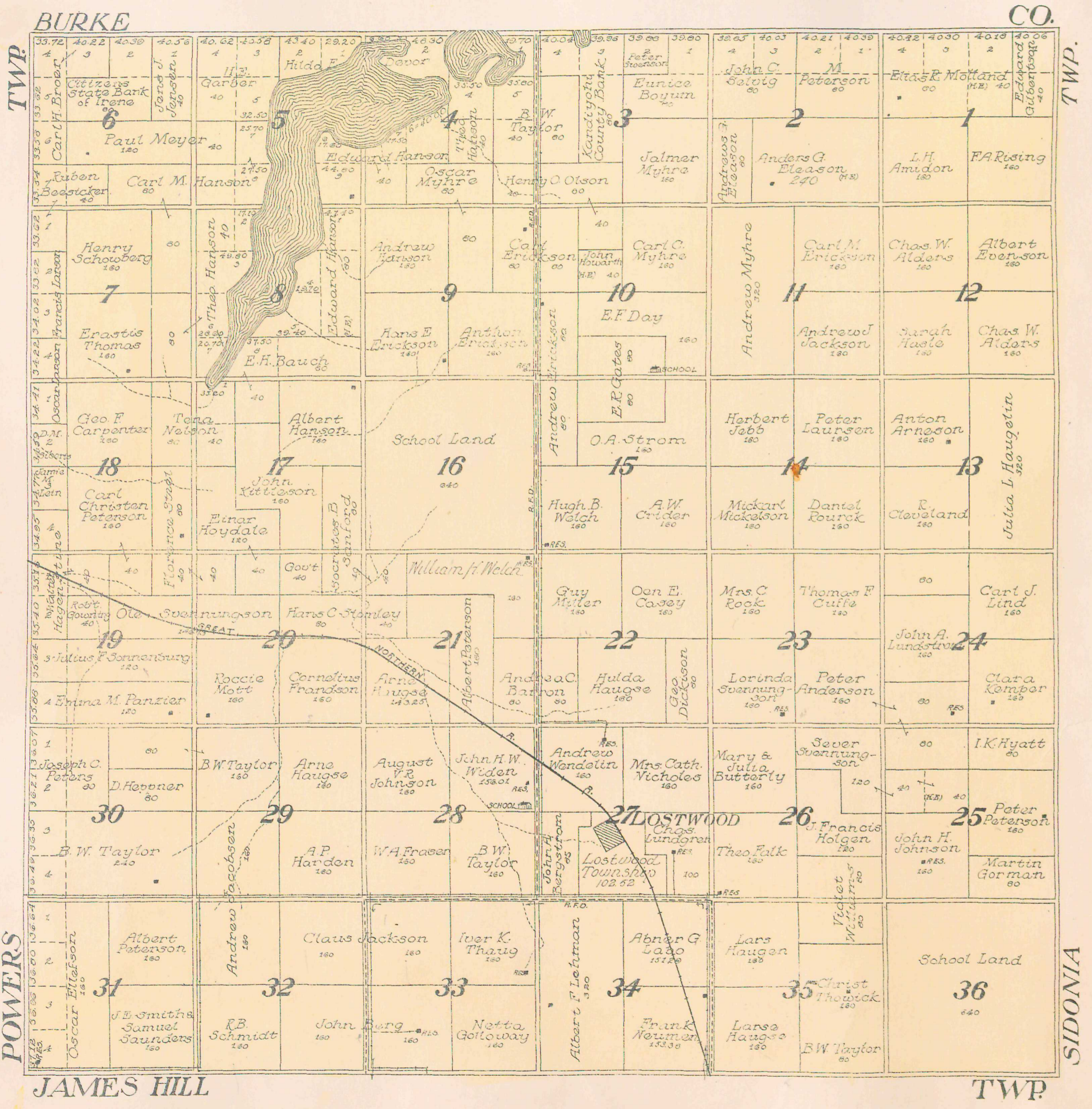

MAP OF
TOWNSHIP 158 N., RANGE 90 W.
OF THE 5th P. M.
Scale 1 3/4 inches to 1 mile

SIDONIA

TWP.	BURKE	CO.	TWP.	
LOSTWOOD	CLEAR WATER	CROWFOOT	TWP.	
3718 3719 3720 3721 3722 3723 3724 3725 3726 3727 3728 3729 3730 3731 3732 3733 3734 3735 3736 3737 3738 3739 3740	2000 2001 2002 2003 2004 2005 2006 2007 2008 2009 2010 2011 2012 2013 2014 2015 2016 2017 2018 2019 2020 2021 2022 2023 2024 2025 2026 2027 2028 2029 2030 2031 2032 2033 2034 2035 2036 2037 2038 2039 2040 2041 2042 2043 2044 2045 2046 2047 2048 2049 2050 2051 2052 2053 2054 2055 2056 2057 2058 2059 2060 2061 2062 2063 2064 2065 2066 2067 2068 2069 2070 2071 2072 2073 2074 2075 2076 2077 2078 2079 2080 2081 2082 2083 2084 2085 2086 2087 2088 2089 2090 2091 2092 2093 2094 2095 2096 2097 2098 2099 2100	39 40 41 42 43 44 45 46 47 48 49 50 51 52 53 54 55 56 57 58 59 60 61 62 63 64 65 66 67 68 69 70 71 72 73 74 75 76 77 78 79 80 81 82 83 84 85 86 87 88 89 90 91 92 93 94 95 96 97 98 99 100 101 102 103 104 105 106 107 108 109 110 111 112 113 114 115 116 117 118 119 120 121 122 123 124 125 126 127 128 129 130 131 132 133 134 135 136 137 138 139 140 141 142 143 144 145 146 147 148 149 150 151 152 153 154 155 156 157 158 159 160 161 162 163 164 165 166 167 168 169 170 171 172 173 174 175 176 177 178 179 180 181 182 183 184 185 186 187 188 189 190 191 192 193 194 195 196 197 198 199 200 201 202 203 204 205 206 207 208 209 210 211 212 213 214 215 216 217 218 219 220 221 222 223 224 225 226 227 228 229 230 231 232 233 234 235 236 237 238 239 240 241 242 243 244 245 246 247 248 249 250 251 252 253 254 255 256 257 258 259 260 261 262 263 264 265 266 267 268 269 270 271 272 273 274 275 276 277 278 279 280 281 282 283 284 285 286 287 288 289 290 291 292 293 294 295 296 297 298 299 300 301 302 303 304 305 306 307 308 309 310 311 312 313 314 315 316 317 318 319 320	3718 3719 3720 3721 3722 3723 3724 3725 3726 3727 3728 3729 3730 3731 3732 3733 3734 3735 3736 3737 3738 3739 3740 3741 3742 3743 3744 3745 3746 3747 3748 3749 3750 3751 3752 3753 3754 3755 3756 3757 3758 3759 3760 3761 3762 3763 3764 3765 3766 3767 3768 3769 3770 3771 3772 3773 3774 3775 3776 3777 3778 3779 3780 3781 3782 3783 3784 3785 3786 3787 3788 3789 3790 3791 3792 3793 3794 3795 3796 3797 3798 3799 3800 3801 3802 3803 3804 3805 3806 3807 3808 3809 3810 3811 3812 3813 3814 3815 3816 3817 3818 3819 3820 3821 3822 3823 3824 3825 3826 3827 3828 3829 3830 3831 3832 3833 3834 3835 3836 3837 3838 3839 3840 3841 3842 3843 3844 3845 3846 3847 3848 3849 3850 3851 3852 3853 3854 3855 3856 3857 3858 3859 3860 3861 3862 3863 3864 3865 3866 3867 3868 3869 3870 3871 3872 3873 3874 3875 3876 3877 3878 3879 3880 3881 3882 3883 3884 3885 3886 3887 3888 3889 3890 3891 3892 3893 3894 3895 3896 3897 3898 3899 3900 3901 3902 3903 3904 3905 3906 3907 3908 3909 3910 3911 3912 3913 3914 3915 3916 3917 3918 3919 3920 3921 3922 3923 3924 3925 3926 3927 3928 3929 3930 3931 3932 3933 3934 3935 3936 3937 3938 3939 3940 3941 3942 3943 3944 3945 3946 3947 3948 3949 3950 3951 3952 3953 3954 3955 3956 3957 3958 3959 3960 3961 3962 3963 3964 3965 3966 3967 3968 3969 3970 3971 3972 3973 3974 3975 3976 3977 3978 3979 3980 3981 3982 3983 3984 3985 3986 3987 3988 3989 3990 3991 3992 3993 3994 3995 3996 3997 3998 3999 4000	TWP.
6 7 8 9 10 11 12 13 14 15 16 17 18 19 20 21 22 23 24 25 26 27 28 29 30 31 32 33 34 35 36	6 7 8 9 10 11 12 13 14 15 16 17 18 19 20 21 22 23 24 25 26 27 28 29 30 31 32 33 34 35 36	6 7 8 9 10 11 12 13 14 15 16 17 18 19 20 21 22 23 24 25 26 27 28 29 30 31 32 33 34 35 36	6 7 8 9 10 11 12 13 14 15 16 17 18 19 20 21 22 23 24 25 26 27 28 29 30 31 32 33 34 35 36	



MAP OF
TOWNSHIP 158 N., RANGE 88 W.
 OF THE 5th P. M.

Scale 1 3/4 inches to 1 mile

LOWLAND

WARD												CO.	
TWP.	35 Maddus Johnson 5	34 Louis Island 40	33 Andrew H. Jacobson 160	32 Jens Hansen 400	31 Karl Hoffman 490	30 James Johnson 180	29 Nick Wilson 160	28 O. King 160	27 R.A. Warren 160	26 Jason Clark 120	25 Hiram H. Baker 120	CO.	
36 Augustus John Wicks 2	35 Andres Arneson 160	34 Jens Hansen 160	33 Fredrick Hoffman 160	32 John J.P. Zupar 160	31 Alexander LeMieux 160	30 B.B. Orcen 120	29 E.J. Thompson 160	28 Hors of Antari King 160	27 Alex. Erickson 160	26 Anna E. Pulten 160	25 Hiram H. Baker 120		
37 Chas. Youngberg 4	36 Eliza Spooner 160	35 Ellen Arneson 160	34 Carl Hoffman 160	33 Alexander LeMieux 160	32 Alexander B. J. LeMieux 160	31 Wm. T. Wheelock 320	30 Louise King 320	29 Hors of Antari King 160	28 Alex. Erickson 160	27 Anna E. Pulten 160	26 Hiram H. Baker 120		
38 O.L. Nore 2	37 Andrew Arneson 160	36 Peter Nielson 160	35 Christ Weigner 160	34 School Land 640	33 Alexander B. J. LeMieux 160	32 Geo. Gustave Lindsey 160	31 Ed. A. King 160	30 Ed. A. Erickson 160	29 J.M. Thornton 160	28 Guy Miller 320	27 Barley Mayhew 320		
39 E.J. Spooner 2	38 Thomas Leavitt 160	37 Jens P. Jensen 80	36 Carl Hoffman 240	35 Christ Weigner 160	34 E.J. Russell 160	33 Milton Scott 240	32 Geo. Moffatt 160	31 Albert Dunis 160	30 Wm. Wentz 160	29 Estate of John B. Kieley 160	28 Guy Miller 320		
40 Eugene J. Spooner 4	39 Eugene J. Spooner 240	38 Geo. H. Spooner 160	37 Jared Clark 160	36 Milton Scott 240	35 Jared Clark 160	34 Thomas Neether 160	33 John J. Egger 480	32 John J. Egger 160	31 J.M. Thornton 160	30 Wm. Wentz 160	29 Estate of John B. Kieley 160		
41 E.J. Spooner 2	40 John T. Martell 160	39 Laurence Ryan 120	38 Jens Olson 80	37 Ole Olson 120	36 John A. Nott 160	35 Elmer J. Ott 80	34 Oscar Johnson 160	33 Albert Dunis 160	32 Max C. Schelak 160	31 Edward Krating 160	30 Guy Miller 320		
42 Jacob W. Kempel 4	41 Hannah Mousley 160	40 G.M. Tharntor 160	39 Michael J. Harley 160	38 Verning Nott 160	37 Carrie Ott 160	36 Mary L. Neether 160	35 Michael B. Erickson 80	34 Peter A. Johnson 160	33 Oscar Johnson 160	32 Olaf Ribb 160	31 Guy Miller 320		
43 Ida B. Jackman 2	42 Louisa King 160	41 W.L. Gottlieb 160	40 Nichols F. Ott 160	39 Ruth Nott 160	38 Anne Dunis 160	37 Robert M. Frank 160	36 Mrs. Nair Jacobson 160	35 Harry Seyman 160	34 School Land 640	33 Guy Miller 320	32 Guy Miller 320		
44 J.M. Thornton 4	43 King Land 40	42 Wm. C. Tharntor 80	41 James Chafer 160	40 John Nott 160	39 J.W. Nott 80	38 Hans Krey 160	37 Sarah Trumble 160	36 Mrs. Caroline Midtbo 160	35 Mark J. Maynard 160	34 School Land 640	33 Guy Miller 320		
STAVE												WARD	
CROWFOOT												TWP.	