

MAP OF

TOWNSHIP 140 N., RANGE 90 W.

 OF THE 5th P. M.

Scale 1 1/4 inches to 1 mile

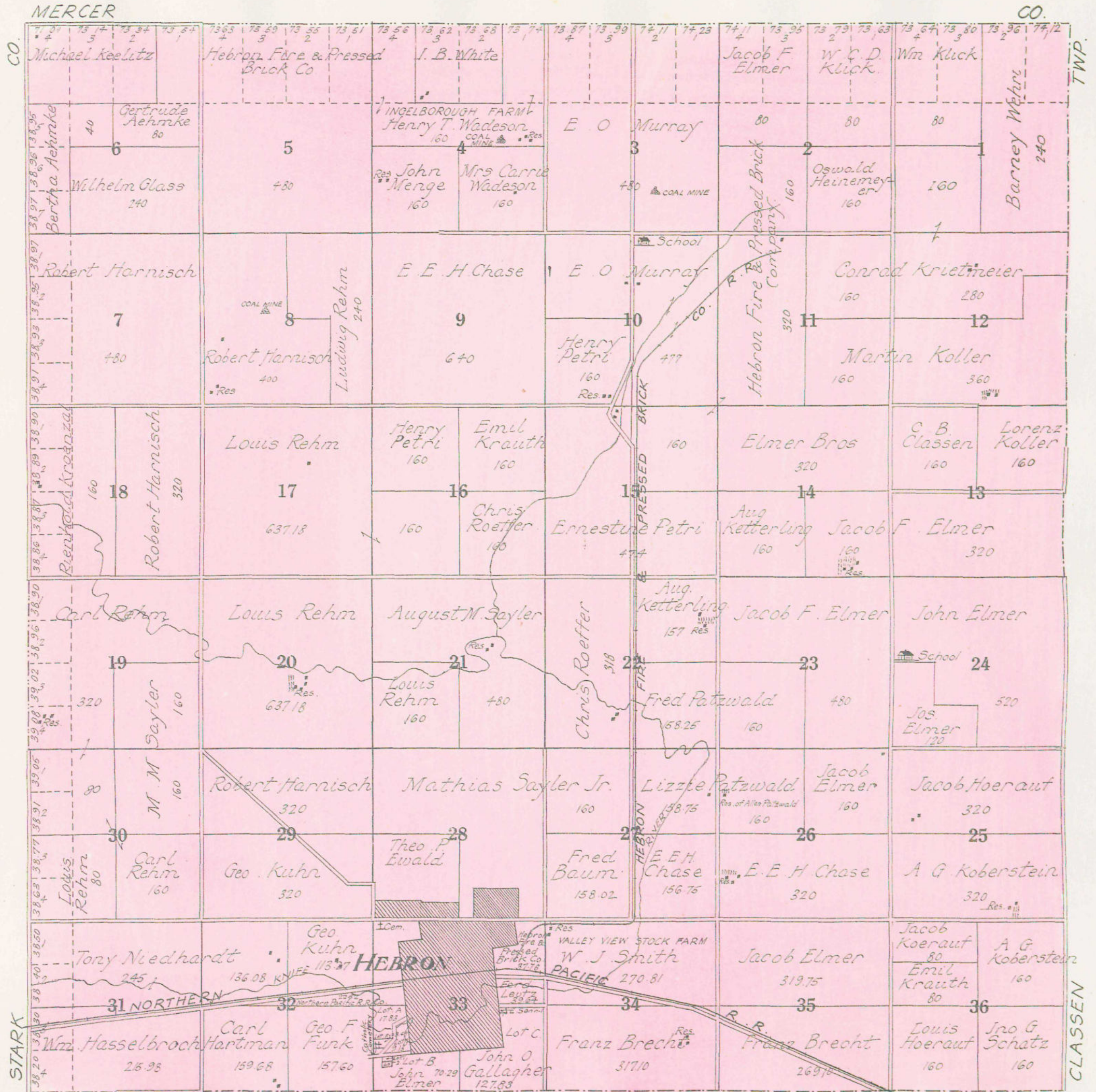

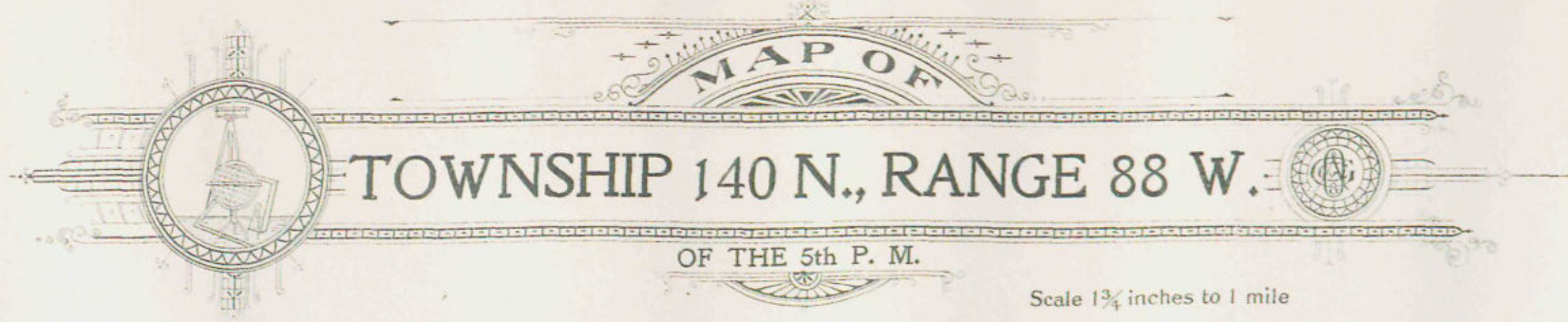

MAP OF

TOWNSHIP 140 N., RANGE 88 W.

 OF THE 5th P. M.

Scale 1 1/4 inches to 1 mile

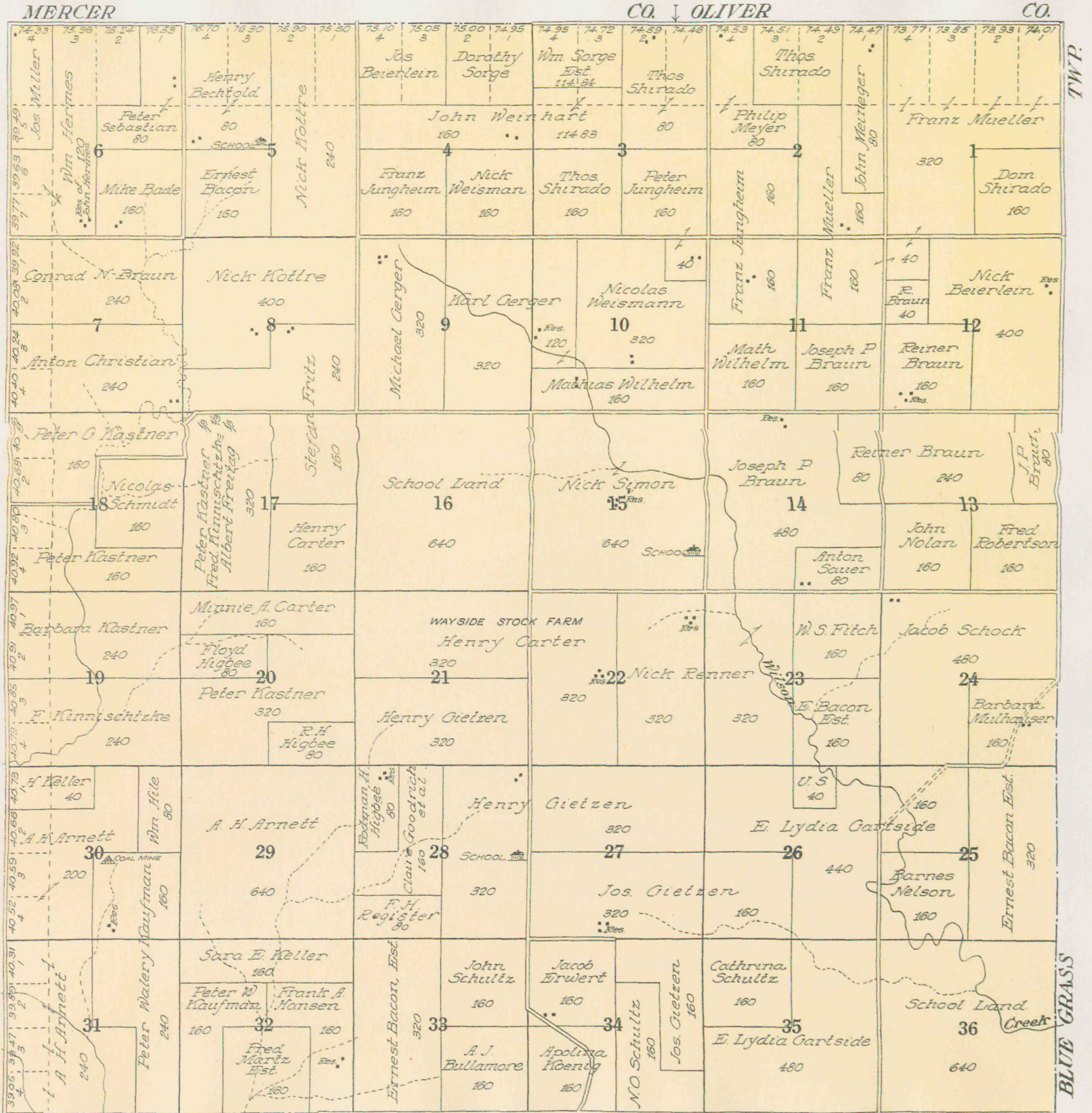



MAP OF
TOWNSHIP 140 N., RANGE 87 W.
 OF THE 5th .P M.
 Scale 1 1/4 inches to 1 mile

OLIVER		CO.					
TWP.	74.52 74.53 74.47 3 2 1 Thos. Schrader	74.43 74.51 74.59 74.67 4 3 2 1	74.72 74.70 74.68 74.66 4 3 2 1 Louie Kockeler Jacob Swager	74.74 74.72 74.70 74.68 74.76 74.86 74.96 75.08 4 3 2 1 4 3 2 1 Wm. Buchmann Peter Redmann	75.14 75.18 75.24 75.31 4 3 2 1 Geo. Bauer		
	3786 4 Matt. Beierlein 80		4 Heirs of Fred Becker 320	3 Carl Bickel 320 Church	2 Heirs of Philip Hartwig 160	1 Chris. Hartwig 80 Heirs of Philip Hartwig 240	
	3750 5 6 7 Geo. Winkler 160	5 Geo. Winkler 480 320	160 William Becker	H. Ostering 160	Carl Bickel 160 School John Bickel 240	Edw. C. Helmenstein 160	
	3725 1 2 3 4 3900 7 Frank Beierlein 160	8 Ino. Mossner 160	Henry Becker 160	9 John Kind 160	10 Carl Ostering 160 320 Theo. Ostering 160	11 Caroling Bickel 80	12 Thos. Conrad Eckwortzell 160 Carolina Bickel 160
	3949 1 2 3 4 3990 18 Joseph P. Braun 80 Reiner Braun 160	Geo. Winkler 160 M. Schida John Mossner (cont.) 160	E. J. Simpson 160 Davis Seter 160	School Land 16 640 School	John Kind 320 George Permann 320	Theo. Ostering 160 Peter Moos 160	Jacob Staus 320 Thos. Conrad Eckwortzell 160 H. A. Treute 160
	4115 1 2 3 4 4174 19 M. Sickle 320 Clara Stubbs 160	20 Michael Gittel 320 Cathrina Kilber 160	21 L. Treute 160 Geo. Permann 160	22 Louis Kroh 160 320 Peter Moos	23 Louis Kroh 160 Eugene Weigel 160 School	24 Thos. C. Eckwortzell 160 H. H. Treute, East 200 Hanna Neuschwand 160 H. A. Treute 240	
	4357 1 2 3 4 4431 30 Barns & Nelson Frank Matutz 160 Peter C. Redmann 160	29 M. Gittel 160 W. H. Mann 160 H. C. Adams 320	HAILSTONE BUTTE 480 HILLSIDE DAIRY & STOCK FARM August Kroh 160 A. T. Anderson 160	27 Peter Moos 160 640	26 H. A. Koeppler 320 CREEK 160 Aug. Gappet 160 80	25 L. Treute 320 DB. Mourse 160 John Steege 180	
	4574 1 2 3 4 4602 31 Jos. Undarick 320	32 Franz Fahr 160 E. Lydia Gartside 160 Ole T. Anderson 160 Geo. Dietz 160	33 W. E. Wilson 320 Fred A. Poppe 160	34 Peter Moos 160 Heirs of Gus Swoboda 320 Eugene Harbold 160	35 640 Matt. Karsh & John Thelon	36 640 School Land	
	CLASSEN						

MAP OF
TOWNSHIP 140 N., RANGE 86 W.
 OF THE 5th P. M.
 Scale 1 1/4 inches to 1 mile

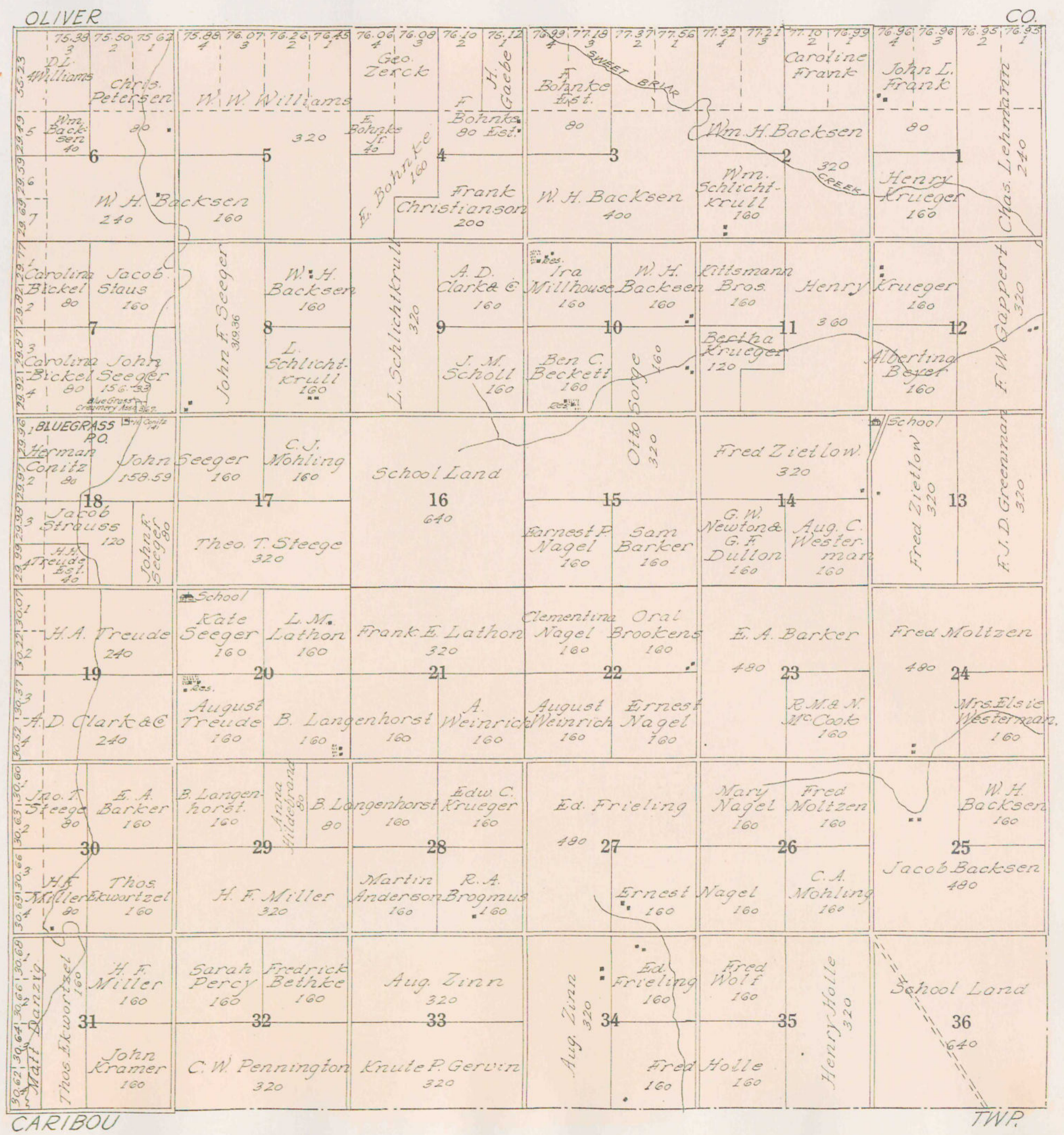

CARIBOU

TWP.

MAP OF
TOWNSHIP 140 N., RANGE 85 W.
OF THE 5th P. M.
 Scale 1 1/4 inches to 1 mile

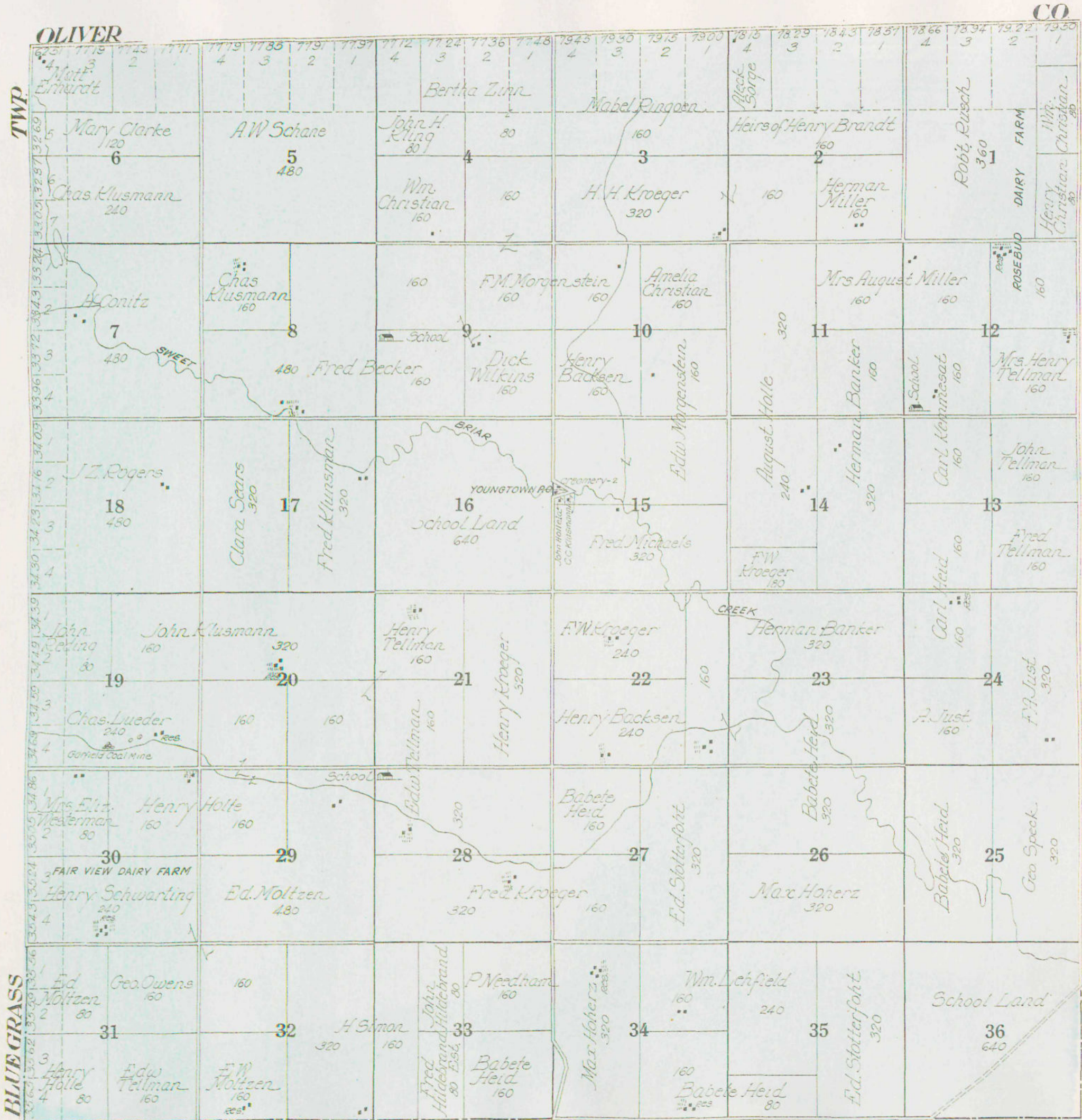

MAP OF
TOWNSHIP 140 N., RANGE 84 W.
 OF THE 5th P. M.
 Scale 1 1/4 inches to 1 mile

OLIVER

CO.

79.59 3 Lundstrum 40 6 Henry Christian 120 7 Henry Christian 120	79.57 2 Henry Christian 160 Herman 160 Golde 199	79.55 1 Christian 80 5 240 Emil 180 Herman Kuehler 160 Mrs. Henry Tellmar 400 Frank Golde 480 Ernest Golde 160 Kurt E. Mathias Deuschel Hoff 160 Mrs. Chas. Matthiesen 320 Chas. Matthiesen 320 Fred Kukuk 160 Emil Richter 160	79.53 1 77.58 1 76.78 4 76.39 3 76.00 2 75.61 1 320 Henry C. Klatt Anna Klatt 80	75.45 4 74.98 3 74.51 2 74.04 1 L. L. Archer (Heirs) 160 H. C. Klatt 160 F. E. Lindner 160 Max Hoessel, Jr. 160 Church F. E. Lindner 160 F. A. Oscar & Clara Munzner Young 160 F. E. Emil Linder Linder 160 160 Herman Kuehler 320 John Dietrich 160 Henry Sporleder 160 Philip Blank 160 John Bloodgood 160 H. A. Koepeller 320 Sohnes Wetch 160 Sohnes Wetch 160 Farmers & Merchants Bank 320	74.26 4 73.18 3 72.10 2 71.02 1 Anton Hoff 120 Kautzman Bros 120 Hattie (Heirs) 80 Henry J. Witting 80 Emanuel Kautzman 160 Oscar & Clara Young 160 Edkins Koedz 160 Anton Koedz 160 Raphael Zander 160 Ed. Hager 160 Fred Kuntz 160 Frank Sporleder 80 Fred Kuntz 160 Carl Hager 320 Aug. Alenburg 320	70.67 4 70.47 3 70.23 2 70.19 1 Val. Fenderer 80 Richard Meyer 80 Henry J. Witting 160 H. Rasch 160 Jos. Gratz 160 Dominic Goetz 320 Max Helbeg 160 Katael Zander 160 Franz Gratz 160 Adolph Just 160 Jas. Gratz 120 State Bank 24 Morton Co. 480 M. Gress 40 L. C. McNelly 160 Peter Dietrich 160 Vincent Stein 320 E. A. Hager 160 Jno. Redinger 160
---------------------------------------------------------------------------------------------	-----------------------------------------------------------------------	---------------------------------------------------------------------------------------------------------------------------------------------------------------------------------------------------------------------------------------------------------------------------------------------------------------	----------------------------------------------------------------------------------------------------------------------------------	----------------------------------------------------------------------------------------------------------------------------------------------------------------------------------------------------------------------------------------------------------------------------------------------------------------------------------------------------------------------------------------------------------------------------------------------------------------------------------------------------------------------------------	------------------------------------------------------------------------------------------------------------------------------------------------------------------------------------------------------------------------------------------------------------------------------------------------------------------------------------------------------------------------------------------------------------------------	-----------------------------------------------------------------------------------------------------------------------------------------------------------------------------------------------------------------------------------------------------------------------------------------------------------------------------------------------------------------------------------------------------------------------------------------------------------------------------------------------

JUDSON

TWP.

MAP OF
TOWNSHIP 140 N., RANGE 83 W.
OF THE 5th .P M.
Scale 1 3/4 inches to 1 mile

OLIVER												CO											
3963 4 Anna Rasch	7066 3 W. Weis	7182 2 G.B. Waite	7300 W. Weis	7391 4 J.O. & A.J. Sylvester	7410 3 J.O. & A.J. Sylvester	7429 2 J.O. & A.J. Sylvester	7447 1 J.O. & A.J. Sylvester	7358 4 Joh. Barth	7362 3 Stein	7366 2 J. Hart	7370 1 Kautzmann	7521 4 Jacob Schaff	7548 3 Jacob Schaff	7576 2 Emil Huber	7603 1 Emil Huber	7537 4 L. Berger	7540 3 L. Berger	7543 2 L. Berger	7546 1 L. Berger	7677 4 Edw. Hagerott	7566 3 Edw. Hagerott	7454 2 Edw. Hagerott	7343 1 Peter Fristad
3515 5 H. Rasch	3574 6 Matt. Hagenbuler	3633 7 Matt. Hagenbuler	3638 1 Herman Rasch	3648 2 M. Tausend Jr.	3658 3 Matt. Hagenbuler	3668 4 H. Kautzmann	3678 5 H. Kautzmann	3688 6 M. Tausend Jr.	3698 7 M. Tausend Jr.	3708 8 Matt. Hagenbuler	3718 9 Emil Hagerott	3728 10 J. Mosbreucker	3738 11 J.F. Bunting	3748 12 Sohanna Mosbreucker	3758 13 W.A. Lanterman	3768 14 Edw. Hagerott	3778 15 Edw. Hagerott	3788 16 Edw. Hagerott	3798 17 Otto Hagerott	3808 18 John Johnson	3818 19 Magdalena Fristad	3828 20 Wm. Fristad	
3636 1 E. Kautzmann	3646 2 Dom Goetz	3656 3 H. Kautzmann	3666 4 R. Kautzmann	3676 5 Arnold Schwizer	3686 6 Arnold Schwizer	3696 7 School Land	3706 8 School Land	3716 9 School Land	3726 10 School Land	3736 11 School Land	3746 12 School Land	3756 13 School Land	3766 14 School Land	3776 15 School Land	3786 16 School Land	3796 17 School Land	3806 18 School Land	3816 19 School Land	3826 20 School Land	3836 21 School Land	3846 22 School Land	3856 23 School Land	
3619 1 M. Gress	3629 2 M. Gress	3639 3 Vincent Stein	3649 4 Vincent Stein	3659 5 Frank Sturn	3669 6 Frank Sturn	3679 7 Frank Sturn	3689 8 Frank Sturn	3699 9 Frank Sturn	3709 10 Frank Sturn	3719 11 Frank Sturn	3729 12 Frank Sturn	3739 13 Frank Sturn	3749 14 Frank Sturn	3759 15 Frank Sturn	3769 16 Frank Sturn	3779 17 Frank Sturn	3789 18 Frank Sturn	3799 19 Frank Sturn	3809 20 Frank Sturn	3819 21 Frank Sturn	3829 22 Frank Sturn	3839 23 Frank Sturn	
3571 1 J. Redinger	3581 2 Peter Schmidt	3591 3 Stephan Sturn	3601 4 Stephan Sturn	3611 5 Frank Sturn	3621 6 Frank Sturn	3631 7 Frank Sturn	3641 8 Frank Sturn	3651 9 Frank Sturn	3661 10 Frank Sturn	3671 11 Frank Sturn	3681 12 Frank Sturn	3691 13 Frank Sturn	3701 14 Frank Sturn	3711 15 Frank Sturn	3721 16 Frank Sturn	3731 17 Frank Sturn	3741 18 Frank Sturn	3751 19 Frank Sturn	3761 20 Frank Sturn	3771 21 Frank Sturn	3781 22 Frank Sturn	3791 23 Frank Sturn	
3420 1 J. Redinger	3430 2 Peter Schmidt	3440 3 Stephan Sturn	3450 4 Stephan Sturn	3460 5 Frank Sturn	3470 6 Frank Sturn	3480 7 Frank Sturn	3490 8 Frank Sturn	3500 9 Frank Sturn	3510 10 Frank Sturn	3520 11 Frank Sturn	3530 12 Frank Sturn	3540 13 Frank Sturn	3550 14 Frank Sturn	3560 15 Frank Sturn	3570 16 Frank Sturn	3580 17 Frank Sturn	3590 18 Frank Sturn	3600 19 Frank Sturn	3610 20 Frank Sturn	3620 21 Frank Sturn	3630 22 Frank Sturn	3640 23 Frank Sturn	

MAP OF
TOWNSHIP 140 N., RANGE 82 W. and
PART of TOWNSHIP 140 N., RANGE 81 W.

OF THE 5th P. M.

Scale 1 1/4 inches to 1 mile

OLIVER

R. 82 W.

R. 81 W.

CO.

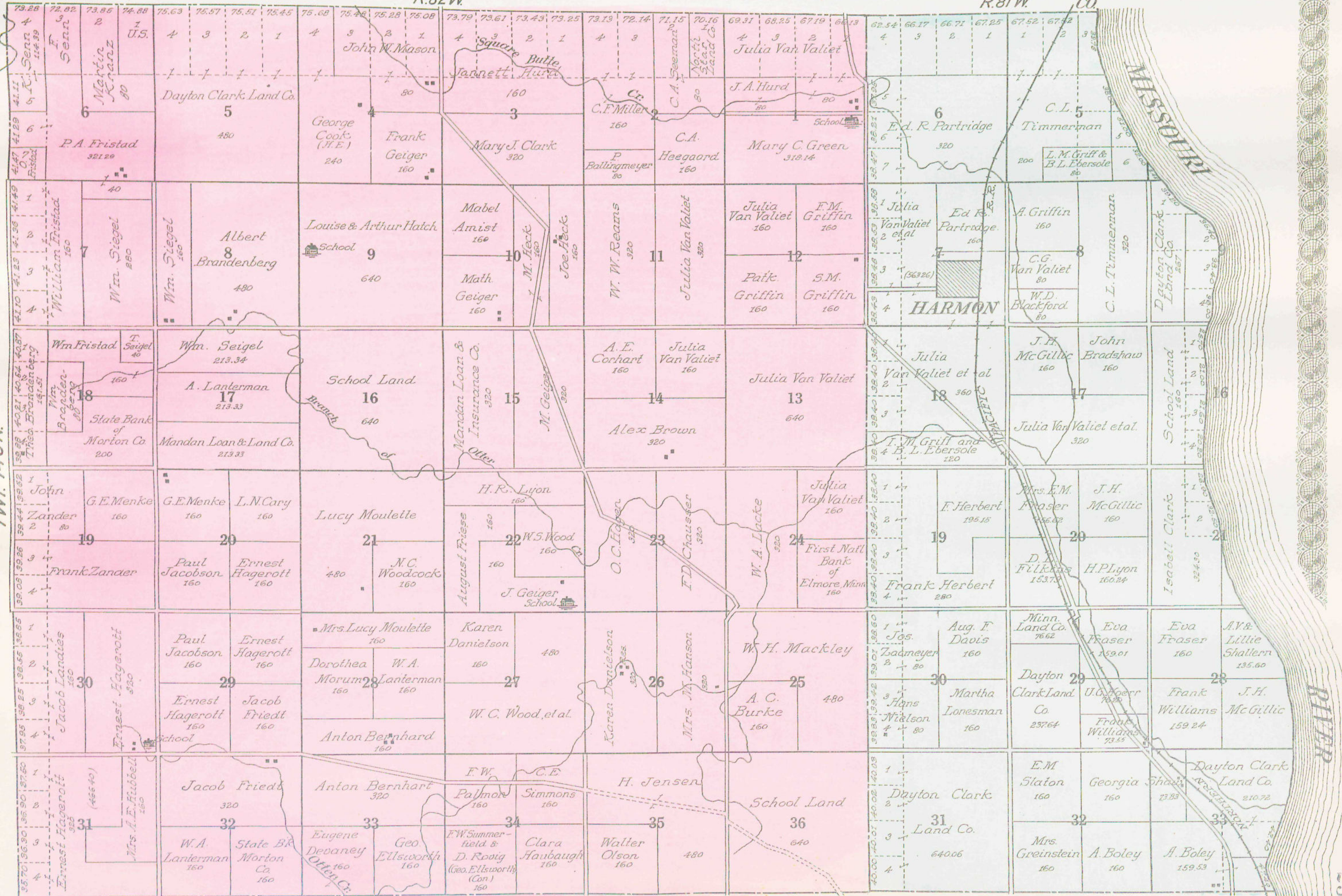

TWP 140 N.