

MAP OF  
TOWNSHIP 138 N., RANGE 90 W.  
OF THE 5th P. M.  
Scale 1 3/4 inches to 1 mile

CUSTER		TWP						
CO.	1	Andrew Lutz 120	Chris Burtmeyer	Witte Heinle 120	Philip Heinle 80	Chris Schmidt 80	Philip Bratzel Sr 80	Philip Bratzel Sr 180
	2	Jacob Staiger 158	5 480	Adolph Heinle 160	Heinrich Schmidt 160	Philip Heinle 320	Wm Schmidt 240	1 180
	3	Ph. Schneider 80	Chris Peltz 160	Christina Mutchelnaus 160	Gotheib Mutchelnaus 160	Adam Heinle 160	Herman Schmidt 160	W. G. Jones 320
	4	Cath. Heinle 240	Chris Heinle 80	Chris Mutchelnaus 320	Chris Mutchelnaus 160	T. C. White 320	R. Buchi Sr 160	W. C. Jones 160
	5	Chris Heinle 400	Chris Mutchelnaus 320	Gotheib Mutchelnaus 320	School Land 640	Northern Pacific Railroad 640	R. Buchi Sr 160	Adam Heinle 160
	6	Wm. J. Meyer 80	Emma Zimmerman 320	Northern Pacific Railroad 160	R. Buchi 160	Simon Maier 160	Rudolph Buchi 160	J. Dittus Sr 160
	7	John Geitzen Sr 120	G. Zimmerman 160	R. Buchi 160	G. Staiger 160	J. T. Nelson 160	Jacob Ulmer 160	Fred De la Barry 160
	8	A. Schneider 120	Schneider 120	R. Buchi 160	G. Staiger 160	J. T. Nelson 160	Jacob Ulmer 160	John Dittus 480
	9	Peter Schatz 280	Jacob Fehr 320	Fred Schneider 320	Mat. Schafer 160	Jacob Ulmer 80	Philip Heinle 80	J. Lanz 160
	10	J. P. & G. J. Schneider 160	Schneider 160	M. Gartner 160	Geo. Saylor 80	Philip Heinle 160	Philip Heinle Jr 160	Henry Lanz 160
	11	T. G. White 320	Jacob Fehr 160	Fredrick Schneider 160	Philip Judt 200	Chris Nuntz 40	Witte Nuntz 40	Jacob Lanz 80
	12	31 320	Fredrick Schneider 160	32 480	Michael Nuntz 160	33 320	Chris Nuntz 200	Philip Heinle 160
	13	32 160	33 160	34 200	35 160	36 640	School Land	
	14	33 160	34 160	35 160	36 160			
	15	34 160	35 160	36 160				
	16	35 160	36 160					
17	36 160							
18								
19								
20								
21								
22								
23								
24								
25								
26								
27								
28								
29								
30								
31								
32								
33								
34								
35								
36								

STARK

GRANT

CO.

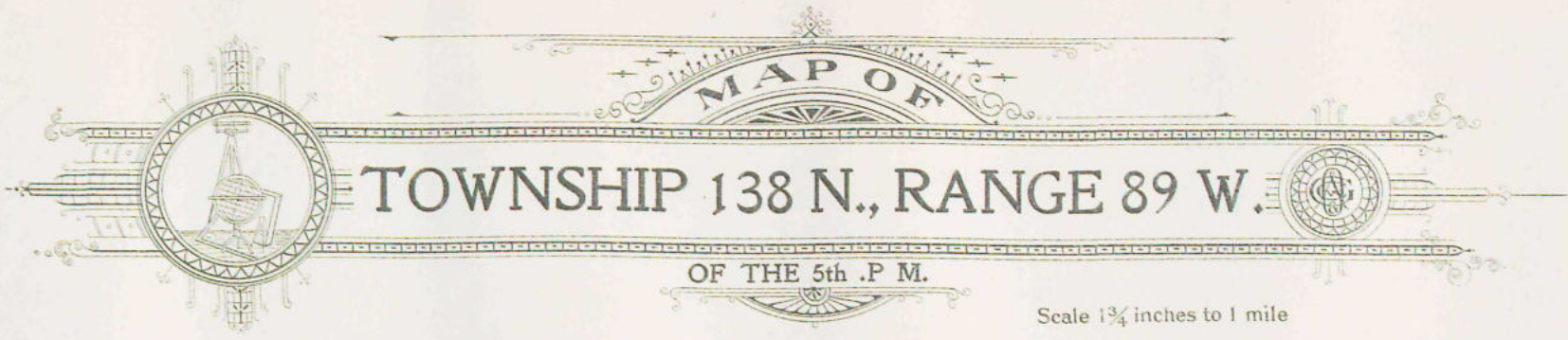

  
**MAP OF**  
**TOWNSHIP 138 N., RANGE 89 W.**  
 OF THE 5th P. M.  
 Scale 1 3/4 inches to 1 mile

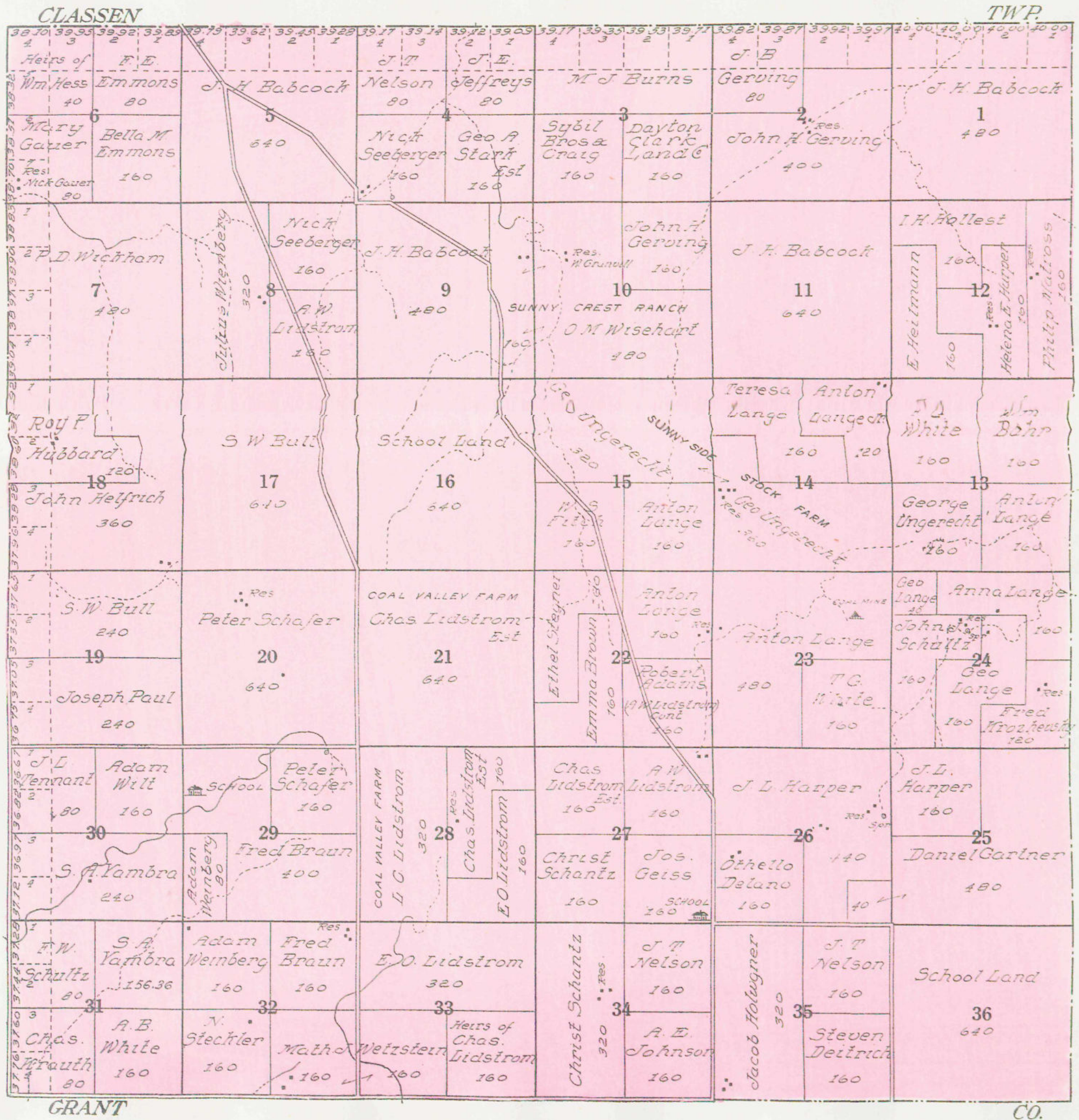

MAP OF  
 TOWNSHIP 138 N., RANGE 88 W.  
 OF THE 5th P. M.  
 Scale 1 3/4 inches to 1 mile

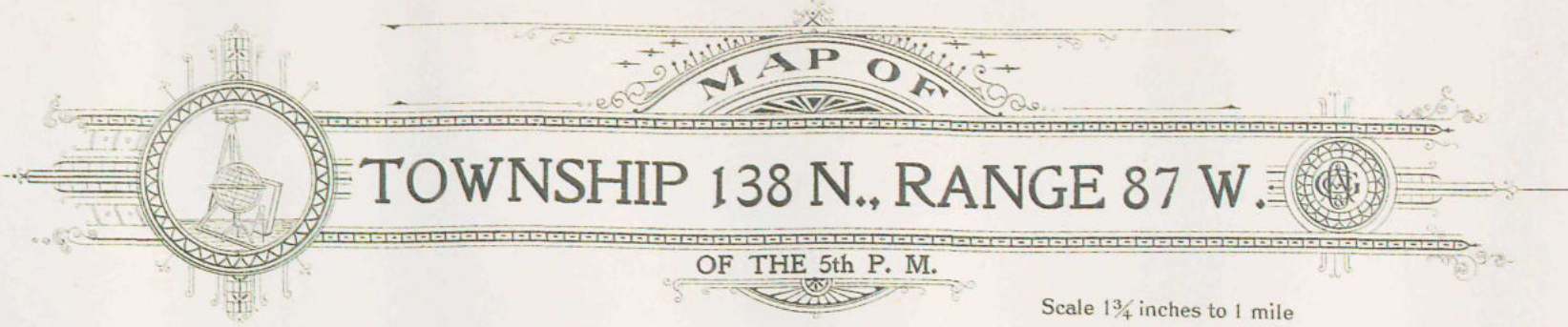

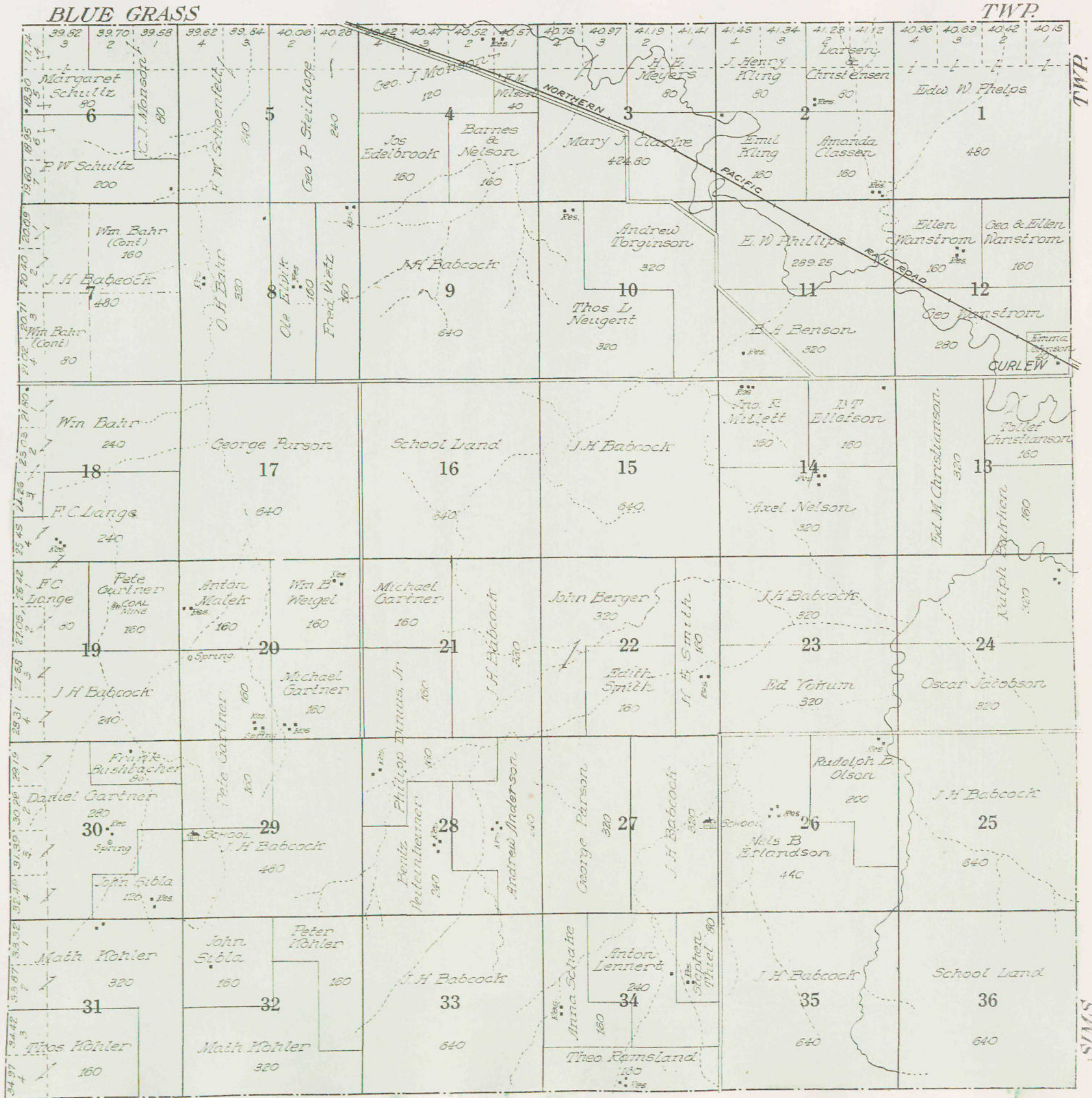

  
**MAP OF**  
**TOWNSHIP 138 N., RANGE 87 W.**  
 OF THE 5th P. M.  
 Scale 1 3/4 inches to 1 mile

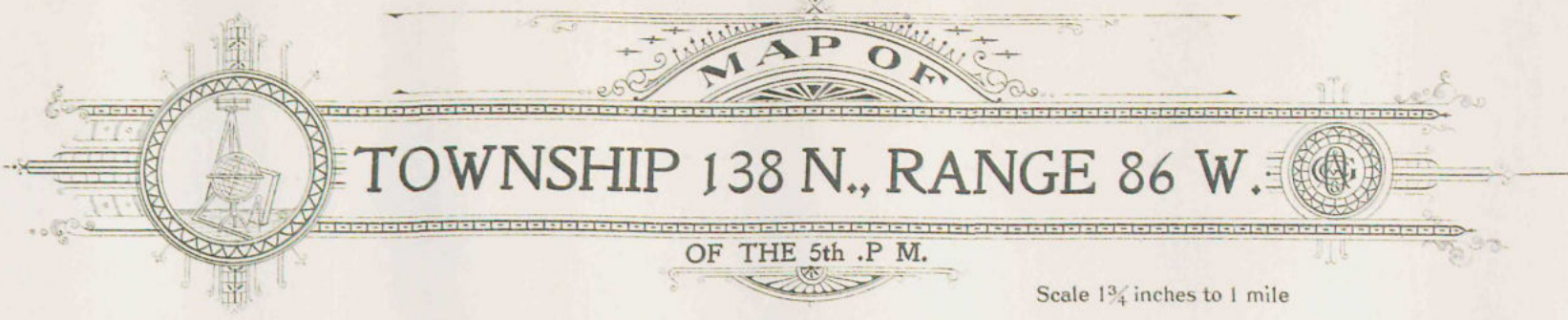

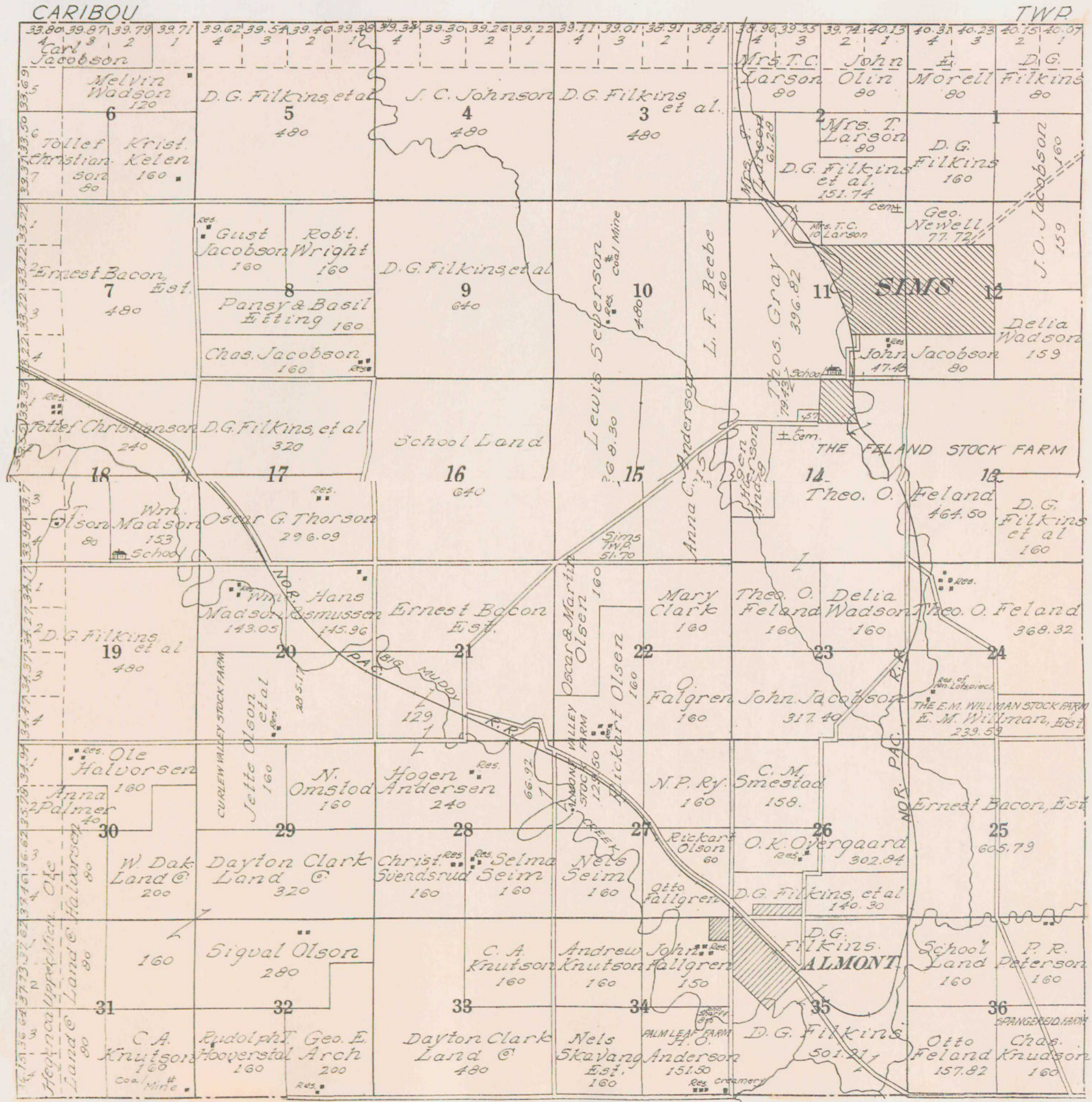

  
**MAP OF**
  
**TOWNSHIP 138 N., RANGE 86 W.**
  
 OF THE 5th .P M.

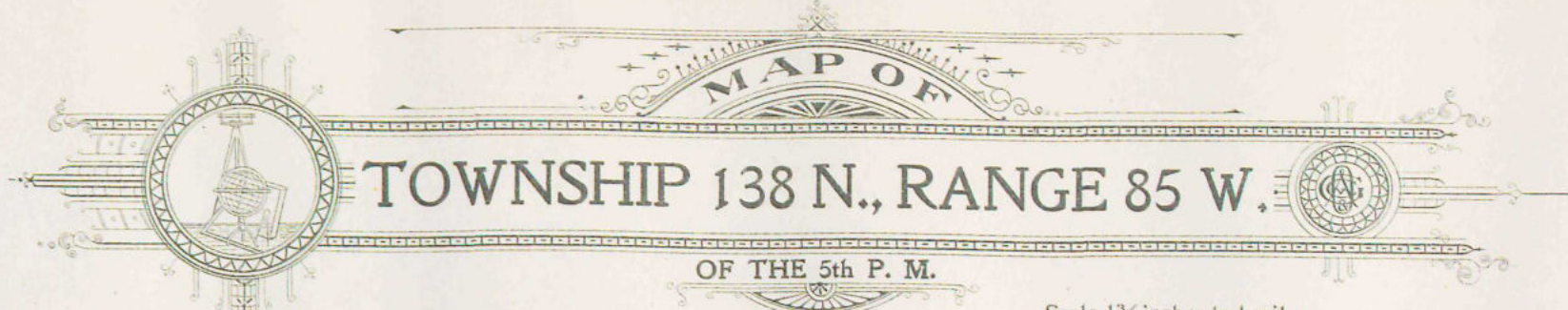
Scale 1 1/4 inches to 1 mile

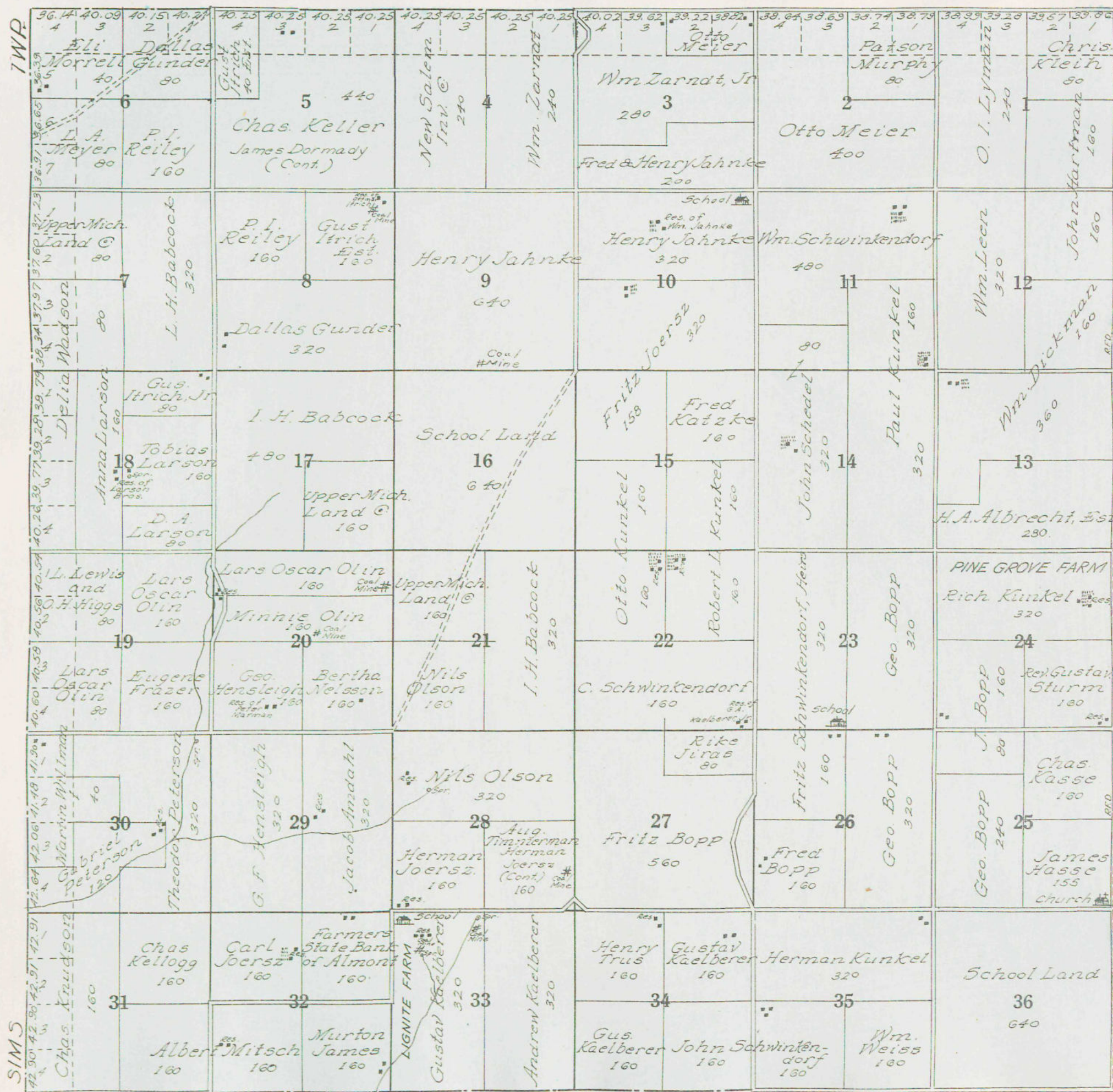

  
**MAP OF**  
**TOWNSHIP 138 N., RANGE 85 W.**  
**OF THE 5th P. M.**

Scale 1 1/4 inches to 1 mile



MAP OF  
TOWNSHIP 138 N., RANGE 84 W.  
OF THE 5th .P M.  
Scale 1 3/4 inches to 1 mile

JUDSON

TWP

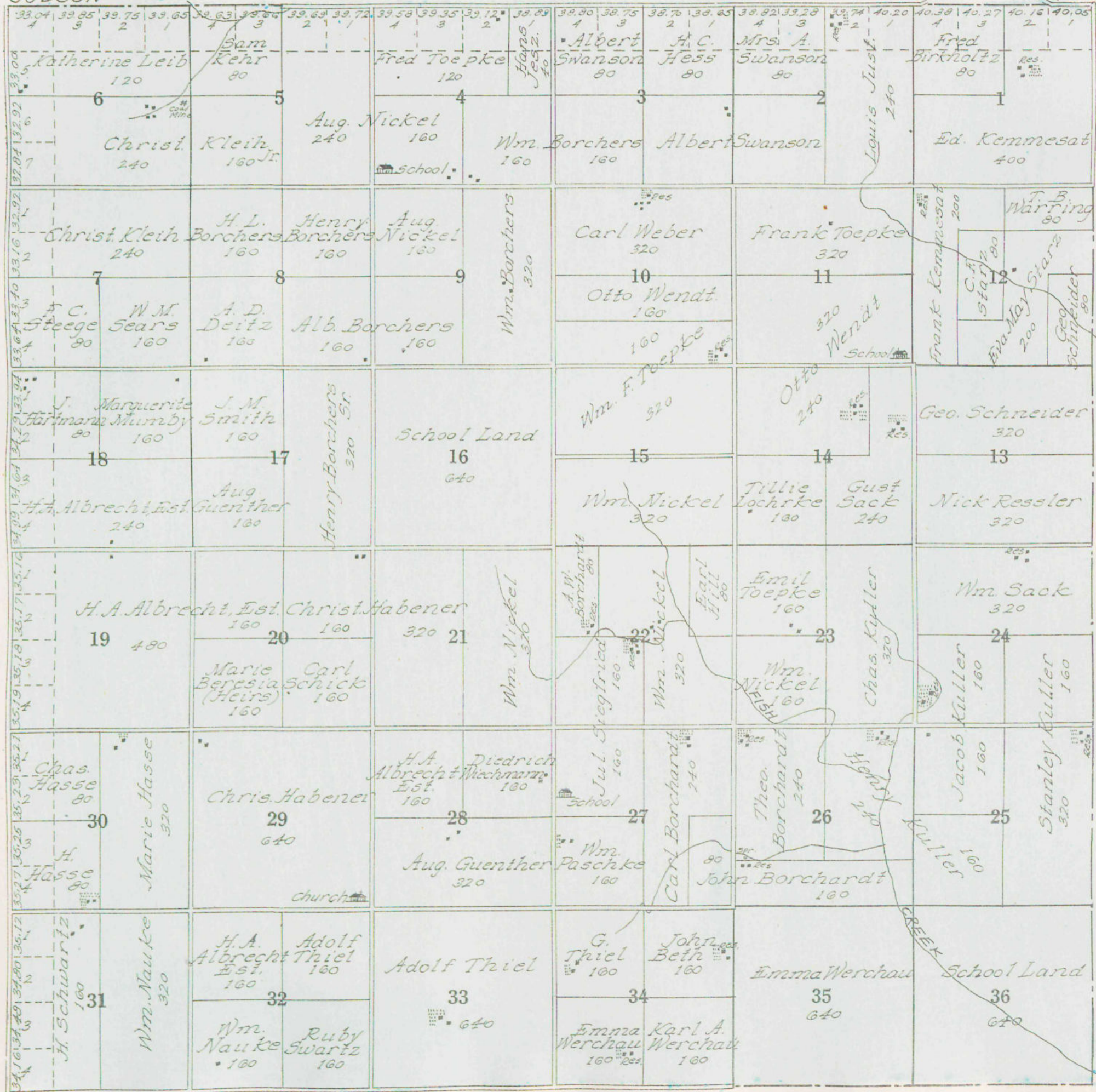

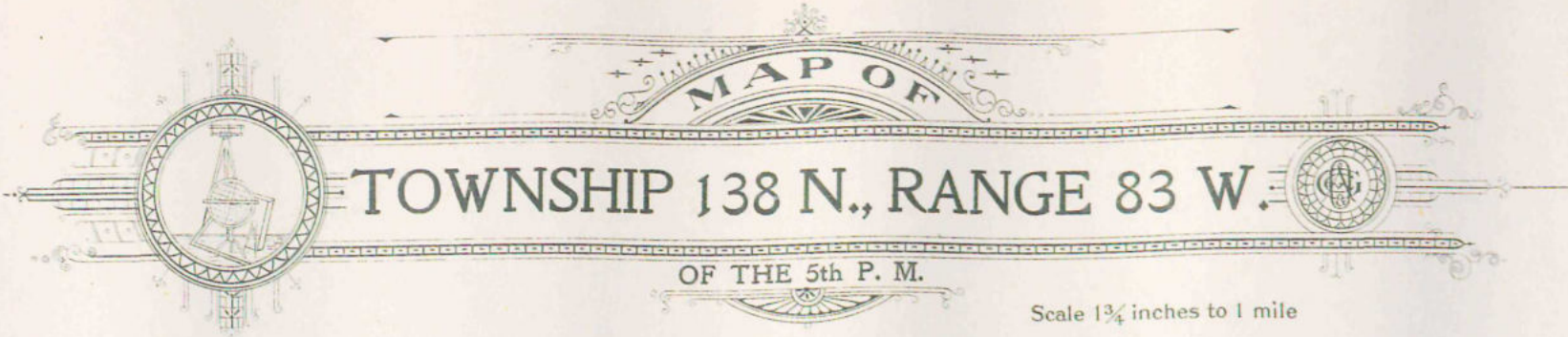

  
**MAP OF**  
**TOWNSHIP 138 N., RANGE 83 W.**  
 OF THE 5th P. M.

Scale 1 1/4 inches to 1 mile

**SWEET BRIAR**

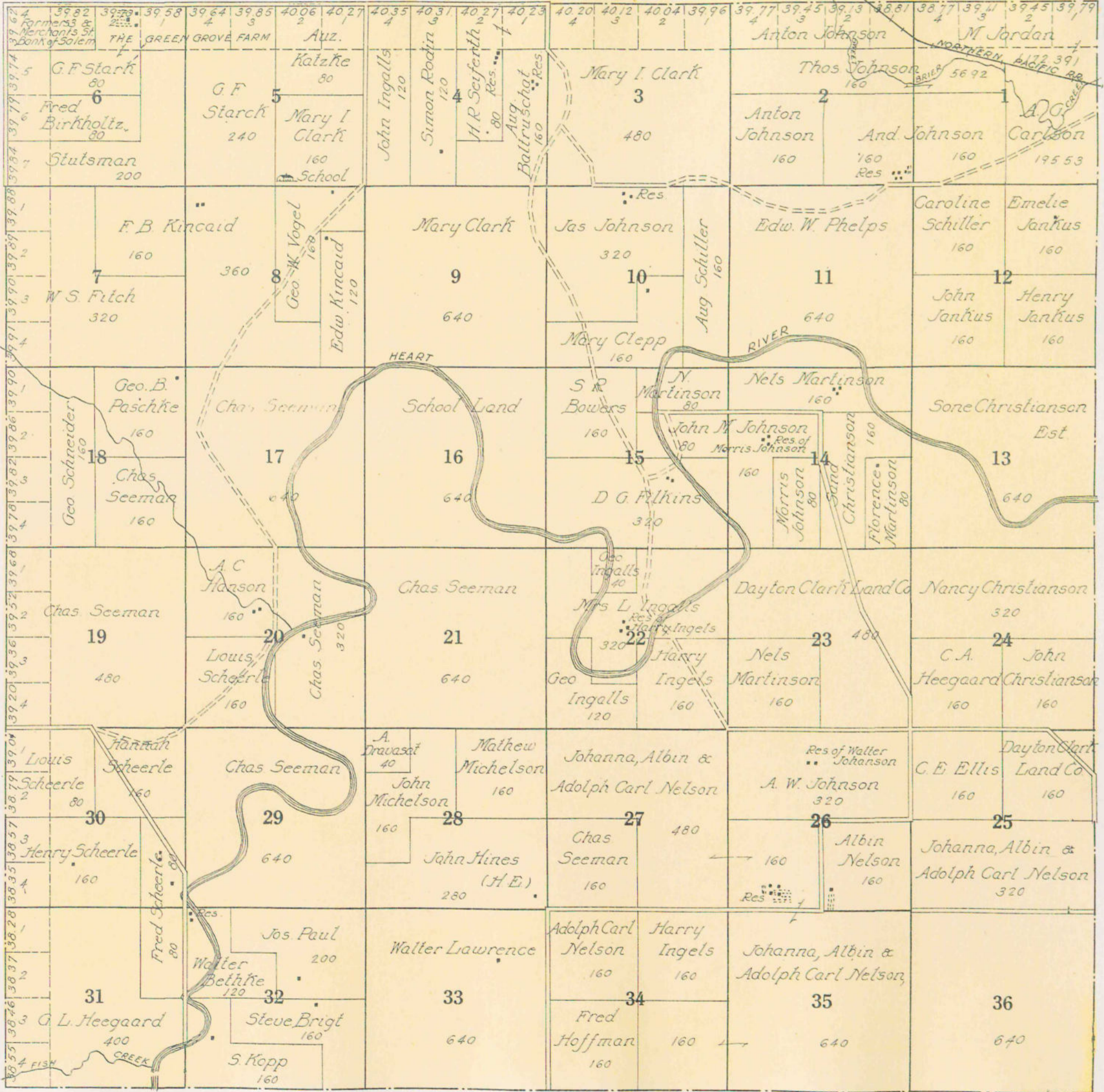
**TWP.**



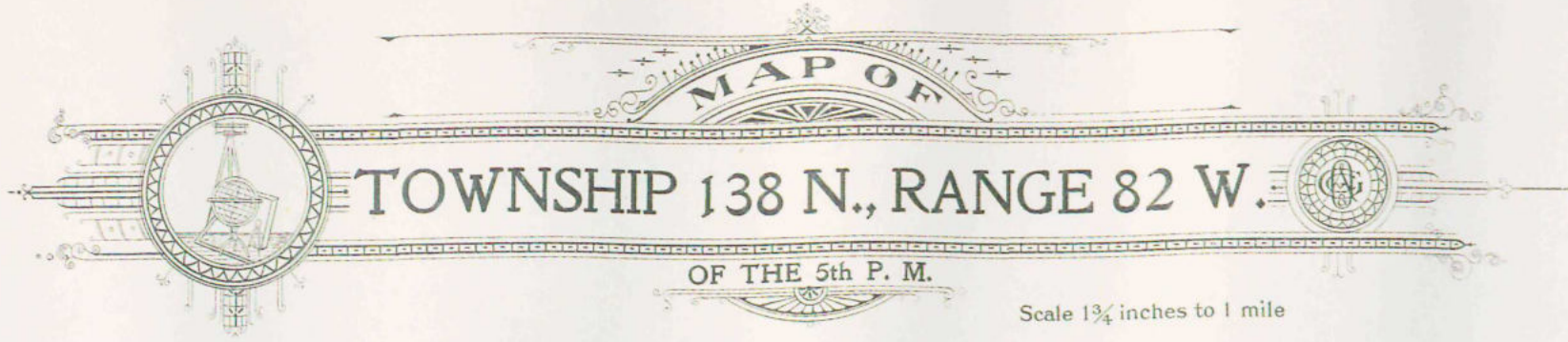

  
**MAP OF**
  
**TOWNSHIP 138 N., RANGE 82 W.**
  
 OF THE 5th P. M.

Scale 1 1/4 inches to 1 mile

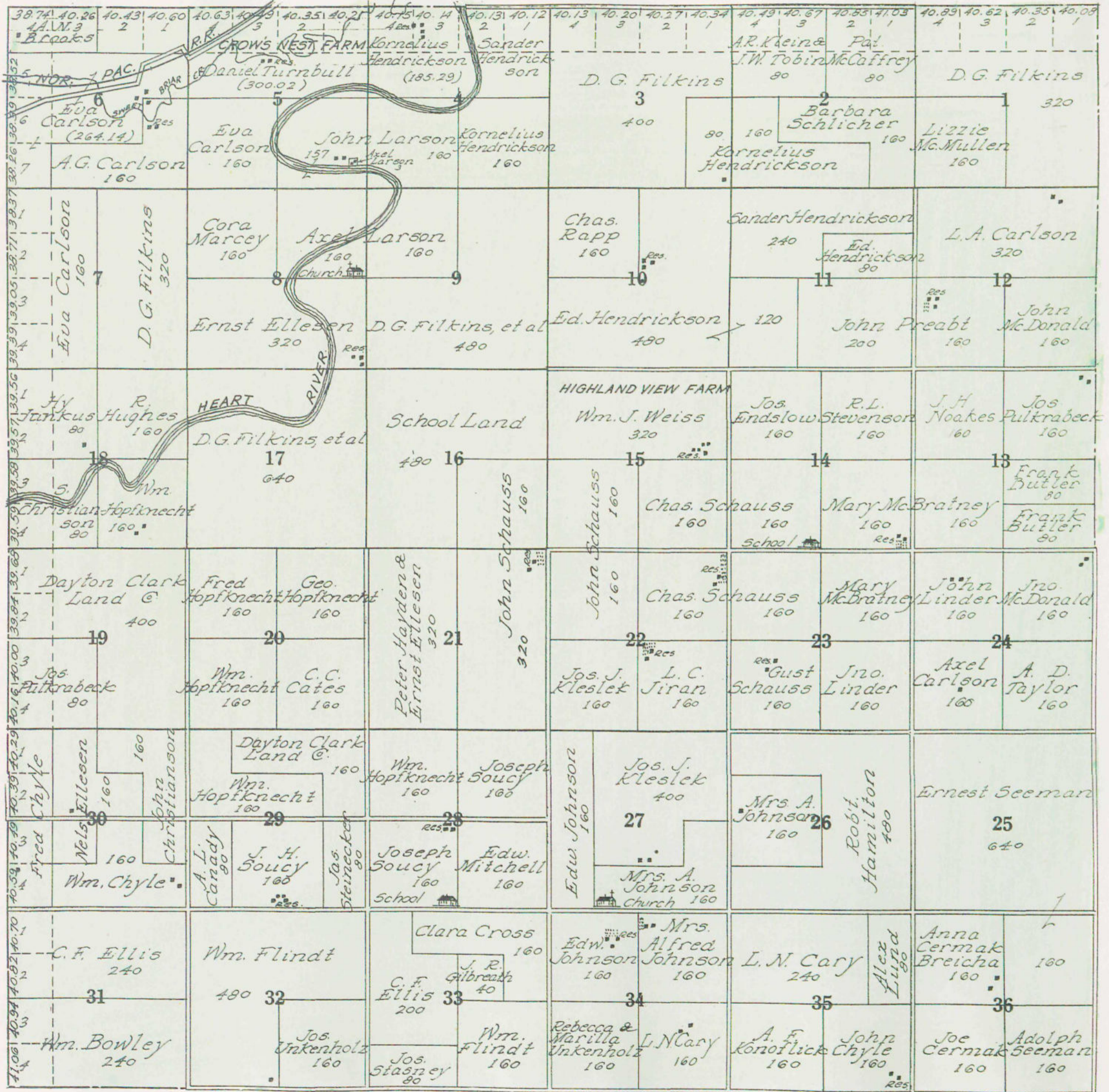

**MAP OF**  
**TOWNSHIP 138 N., RANGE 81 W. and**  
**PART of TOWNSHIP 138 N., RANGE 80 W.**  
**OF THE 5th P. M.**  
 Scale 1 1/4 inches to 1 mile

