

MAP OF
TOWNSHIP 136 N., RANGE 84 W.
OF THE 5th .P M.
Scale 1 1/4 inches to 1 mile

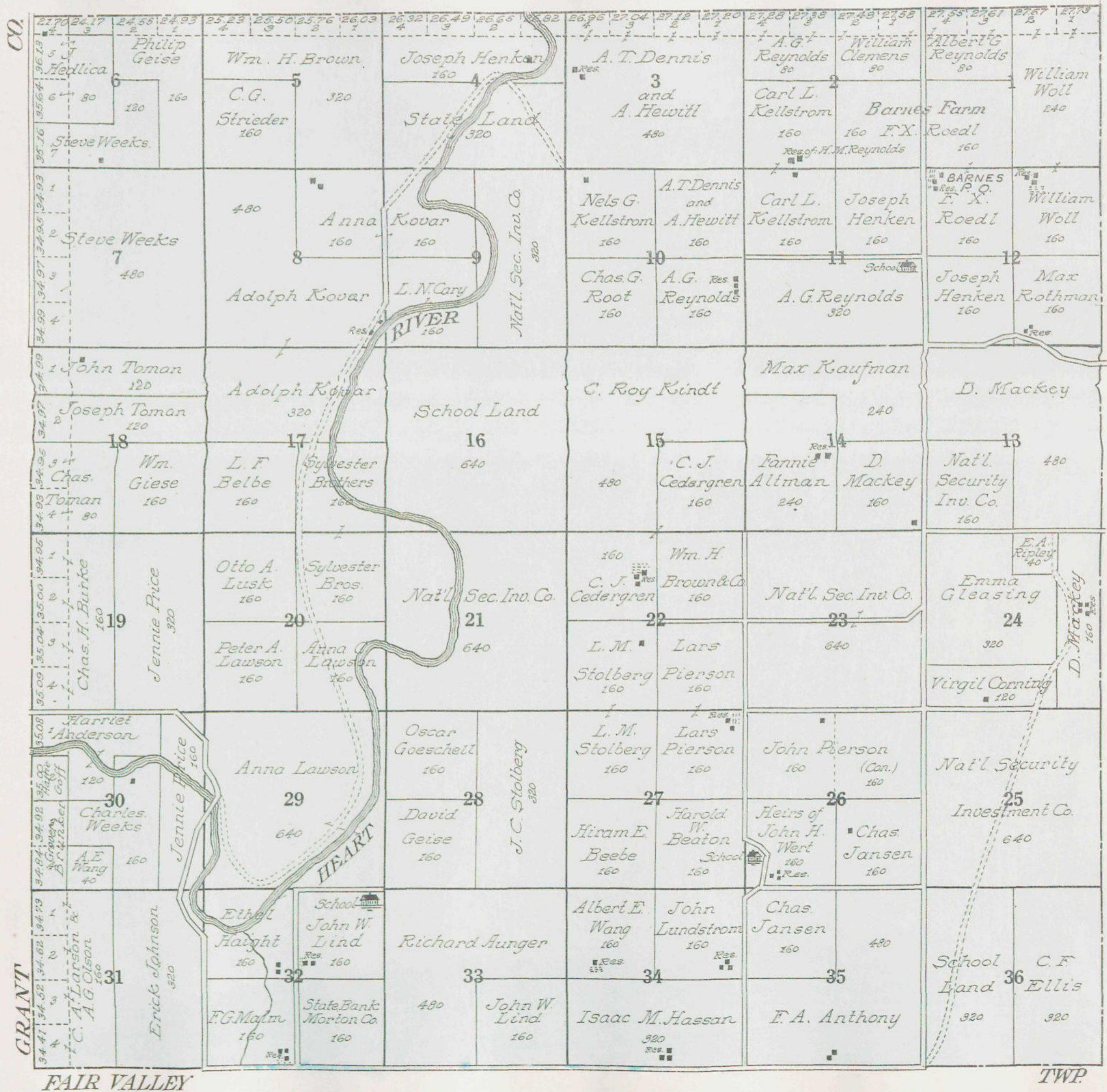

MAP OF
TOWNSHIP 136 N., RANGE 83 W.
OF THE 5th P. M.

Scale 1 1/4 inches to 1 mile

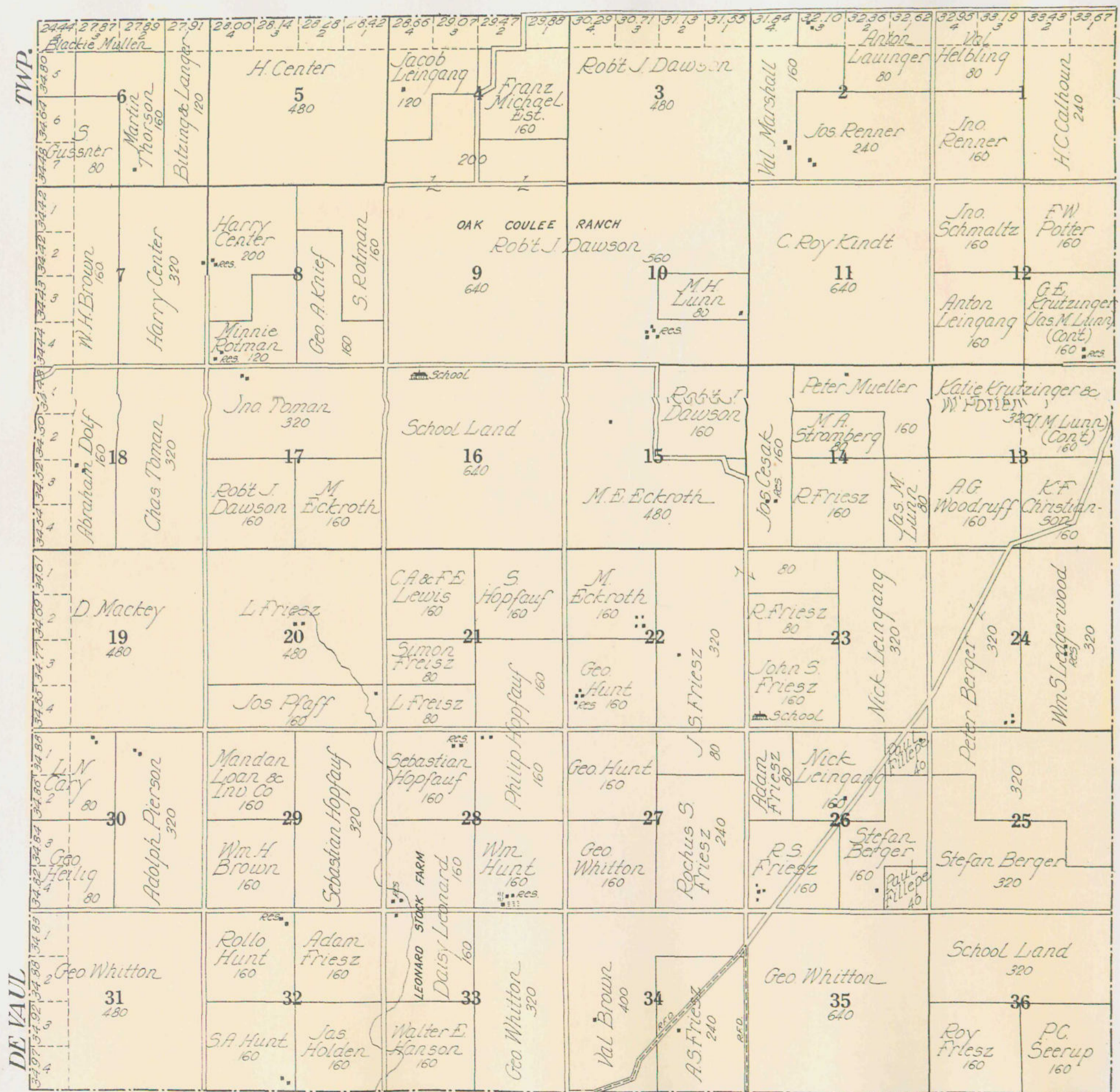

MAP OF
TOWNSHIP 136 N., RANGE 82 W.
 OF THE 5th .P M.
 Scale 1 3/4 inches to 1 mile

34.09 34.98 35.78 36.58 37.40 38.18 38.96 39.74 40.44 41.12 41.80 42.48 43.11 43.62 44.13 44.64 45.19 45.60 46.01 46.42 46.60 47.24 47.88 48.52	Frank Truka 5 40	John E. Zellman 2 80	Anton Cinoto 4 80	Anton Veronda 2 80	Jos. Balbinot 80	Louis Veronda 80	Jacob Steckler 1 80	John Miska 80	Albert Canady 160	A. Damsky 160	Math. Renner 240	Val Helbling 80	Mag Knoll 240
34.18 34.18 34.26 34.26	I. R. Gilbreth 240	John W. Johnson 160	Jos. Balbinot 80	Louis Veronda 80	Jacob Bleih 160	Sara Ward 160	Heirs of Peter Williams 160	80	J. E. Zelmar 160	Mag Knoll 240			
34.37 34.37 34.46 34.46 34.54 34.54 34.63 34.63 34.71 34.71	H. A. Calhoun 240	J. J. Strain 160	Jos. Huncovsky 160	And. Lauriston 160	Pauline Bullinger 160	Mike Bullinger 160	Caroline Kingsley 320	Adam Bullinger 160	Mag Knoll 160				
34.71 34.71 34.80 34.80 34.88 34.88 34.97 34.97	Jos. Seiler 4 80	Math. Renner 160	J. H. Noakes 160	J. J. Strain 160	Math. Renner 160	W. H. Brown 160	B. W. Shaw 160	Clara Bullinger 160	Wm. Shields 160	Frank Haider 160	E. Helbling 160		
34.97 34.97 35.05 35.05 35.13 35.13 35.21 35.21	Eliz. Renner 240	Wm. Linde 160	J. P. Gilbraith 160	School	F. J. Seiler 160	Henry Knoll 320	Henry Knoll 320	L. N. Cary 640					
35.21 35.21 35.29 35.29 35.37 35.37 35.45 35.45	H. C. Johnson 4 80	Joe Tomanek 160	J. J. Strain 320	John V. Helbing 320	Dom. Bender 320	John T. Seiler 160	Henry Knoll 320	Joint Leingang 160	Peter Schantz 160				
35.45 35.45 35.53 35.53 35.61 35.61 35.69 35.69	John Greet 240	John Suchy 160	Peter Cogsgrove 160	C. Roy Kindt 320	L. Norsiny 80	Delta Nichols 160	Joint Leingang 160	Peter Schantz 320	Casper Schantz 200	Geo. Kupper 160	Anton Wetch 160		
35.69 35.69 35.77 35.77 35.85 35.85 35.93 35.93	C. Roy Kindt 240	John Suchy 160	Anton Broscha 160	John A. Jarboe 160	Jay H. Crawford 160	C. Roy Kindt 320	Anna Bender 320	Joint Leingang 80	Joint Leingang 320	(Joseph Morrell) (Contract)	200	Anton Wetch 160	
35.93 35.93 36.01 36.01 36.09 36.09 36.17 36.17	H. L. Henke 120	Math. Schmidt 480	John A. Jarboe 160	Emil Fisher 320	Karl Bender, Sr. 160	Barbara Beba 160	Anna Bender 320	Jos. Morrell 160	Carl Bender 160	Anton Wetch 160			
36.17 36.17 36.25 36.25 36.33 36.33 36.41 36.41	E. Dworschak 200	R. Auger 480	John A. Jarboe 160	Emil Fisher 320	Karl Bender, Sr. 160	Barbara Beba 160	R. Auriger 160	Sam Boyd 160	W. G. Wheeler 160	Jacob Bullinger 160	Declow Bender 320		
36.41 36.41 36.49 36.49 36.57 36.57 36.65 36.65	P. C. Seerup 480	P. C. Seerup 160	John Dworschak 360	B. P. Davidson 640	Philip Schaefer 160	Barbara Fairairzl 160	John Hucovsky 160	R. Augner 160	John Morrell 160	Anton Wetsch 160	Martin Klein 160		
36.65 36.65 36.73 36.73 36.81 36.81 36.89 36.89							Jos. Fairairzl 160	Frank Barth 160	R. Augner 160	School Land 160	Fr. Leingang 160		

COPENHAGEN

TWP.

MAP OF
TOWNSHIP 136 N., RANGE 81 W.
 OF THE 5th .P. M.
 Scale 1 3/4 inches to 1 mile

41.31 49.37 4 3 Anton Buehler 5 40 Heirs of Peter Miller 6 80 33.67 33.65 33.67 33.65	49.55 49.72 2 1 Michael Pitzer 6 Sam Albert 80 ST. ANTHONY	50.01 50.69 4 3 51.37 52.05 2 1 A. S. Stutsman 5 480	52.70 53.20 4 3 53.70 54.20 2 1 Frank Haider 4 Math Weigel, Jr. 40 Morton L. & R. Co. 160	54.40 54.85 4 3 55.29 55.74 2 1 Harold Beaton 80 Anton Mann 160 Michael Pitzer 240	57.13 57.53 4 3 57.93 58.30 2 1 Frank Pitzer 80 Edw. Wooley Est. 160 Mike Gatte 160 Grace Wooley 40	57.96 58.53 4 3 59.09 59.66 2 1 Michael Pitzer 160 Stephan Tokach 320
Heirs of Peter Miller 1 80 33.74 33.72 33.74 33.72 33.74 33.72	Frank Haider Sr. 160 ST. ANTHONY	Frank Haider Sr. 160 Math Weigel Sr. 160	Math Weigel 160 John Mann 160	Anton Mann 160 Joseph Helbling 160 Ben Staehne 160 State Bank of Morton County	Joseph Schmidt 640	Sandra Norbovi Victor Parala (Cont.) 120 Stephen Tokach 160 Victor Parala 200 Anton Krois 100
Frank Haider 2 80 33.88 33.86 33.88 33.86 33.88 33.86	Peter Leinoang 160 Nicolas Martin Heirs 159	Leinoang 160 Lucos Leinoang Est. 160 John Mann 160 School	John Opitz 160 John Opitz 320	John Opitz 320 Paul F. Miller 320	John Opitz 160 Math Gatte 200 Andrew M. Miller	Carl Mueller 320 Geo. Klein Valley Farm 314
Frank Haider 2 80 33.95 33.93 33.95 33.93 33.95 33.93	Nick Bender Jr. 160 FM Klein 160	Dom Bender 80 Chris Schaaf 160 Val Bender 160 Nick Bender, Jr.	Erasmus R. Helbling 21 240	A.C. Miller 160 John Brigg 160 Paul F. Miller 160 Wm Simpson (John Brigg) (Cont.)	Heirs of Peter Miller 320 Frank Miller 320	Katherine Ripple 320 Martin Zierhut 320
Mike Krois 160 33.99 33.97 33.99 33.97 33.99 33.97	Mike Krois 160 Stephan Haider 160	ER. Helbling 160 Martin Klein 330	ER. Helbling 160 Chris Hoffman 160 Katherine Mopsige 160	J. B. Dawson 160 Frank Miller (Cont.) 160 Morton Co. State Bank 160 Regina Miller 160	Frank Miller 160 Lena Miller 160 Carrie Miller 160 Joseph Miller 160	Heirs of Peter Miller 320 Joseph Schmidt 320
Adam Weizstein 2 80 34.11 34.09 34.11 34.09 34.11 34.09	Decklow Bender 160 Geo. T. Wetach 160	George T. Wetach 160 Daniel Haider 160 Jos. Kuntz 160 School	Chris Hoffman 320 Chris. Schaaf 320	Dora Holt 160 Kath. Magelge 40 Matt Magelge 120 Louise Staehne 160 State Bank of Morton Co. 160 Heirs of Peter Miller 160	State Bank of Morton Co. 160 Heirs of Peter Miller 160 Lena Small 320	School Land 640

MAP OF
TOWNSHIP 136 N., RANGE 80 W.
 OF THE 5th P. M.
 Scale 1 3/4 inches to 1 mile

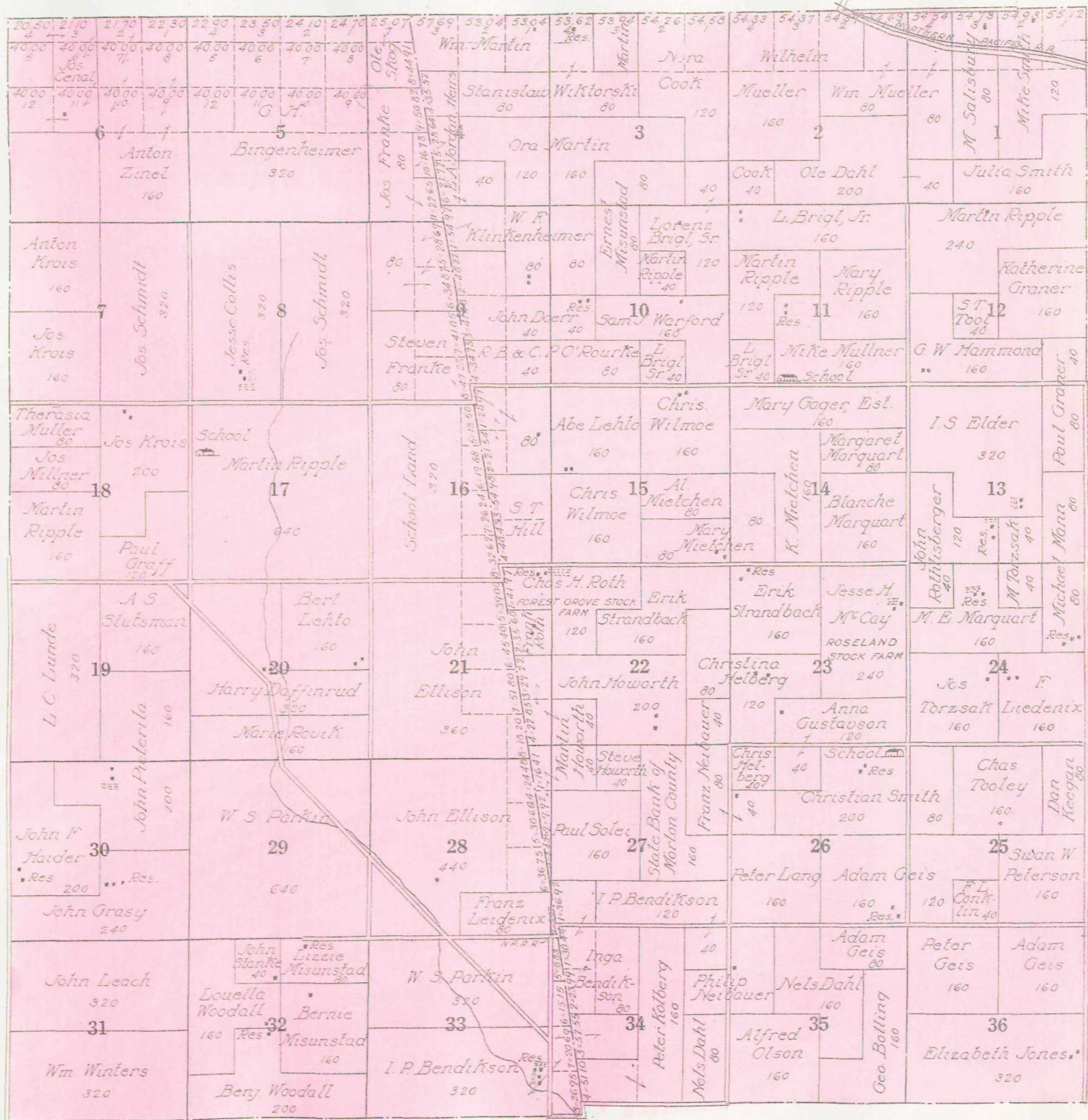

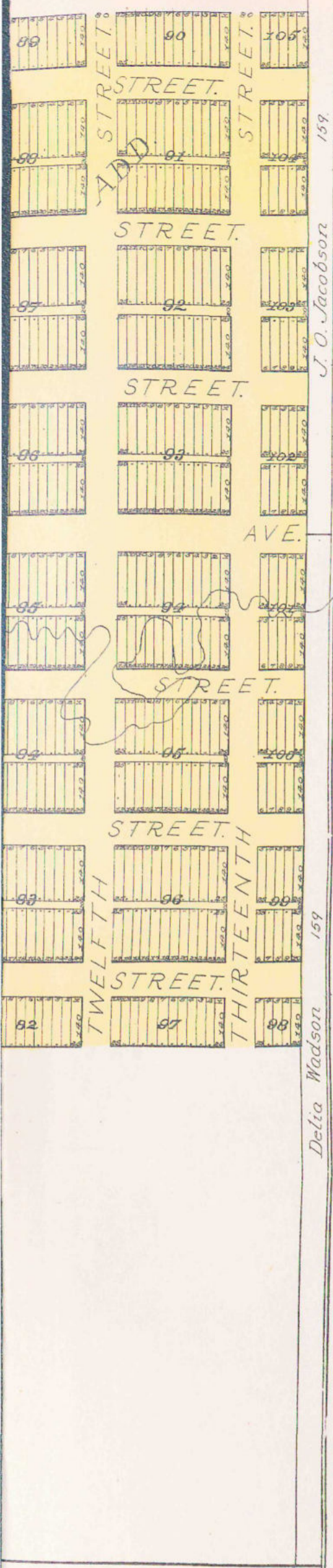

J. O. Jacobson
Delta Madison

MAP OF
 Part of Township 136 N., Range 79 W.
 OF THE 5th .P M.
 Scale 1 3/4 inches to 1 mile

