

MAP OF
TOWNSHIP 134 N., RANGE 87 W.
OF THE 5th P. M.
Scale 1 3/4 inches to 1 mile

TWP	37.07 4 F. D. Stoller 120	40.09 3 Mandara Land Co.	40.18 2 Mandara Land Co.	40.07 1 Mandara Land Co.	40.00 4 J. W. Niest 80	39.94 3 Jacob Spoller 80	39.92 2 Jacob Stoller 80	39.84 3 M. Shaw 80	39.82 4 John Matt 80	39.94 3 Christian Fietman 80	40.06 2 Jennie Voit 160	40.18 1 John Huber 160	40.21 5 M. S. Keierleber 160	40.15 6 M. Dowall 160	40.09 7 M. Dowall 160	40.03 8 M. Dowall 160	TWP
	6 First Loan & Sec. Co. 80	5 Emma Vought 160	5 Fred Stoller 160	5 John Scherer 160	4 Fred Stoller 160	4 John Scherer 160	3 Thos. M. Dowall 320	3 Thos. M. Dowall 320	2 Geo. Kierleber 160	2 John Huber 160	1 M. S. Keierleber 160	1 M. S. Keierleber 160	1 M. S. Keierleber 160	1 M. S. Keierleber 160	1 M. S. Keierleber 160	1 M. S. Keierleber 160	TWP
	1 Ludwig Keller 160	7 August Boesche 160	8 Jacob Sauter 240	8 John Scherer 480	9 Jacob Sauter 160	10 Chris Reister 160	10 Christ Sauter 160	10 Geo. Berreth 160	11 L. M. Shaw 160	11 Henry Diehl 160	11 Andrew Hallenberger 320	12 Geo. Keierleber 160	12 H. Hallenberger 320	12 Henry Keierleber 160	12 Henry Keierleber 160	TWP	
	1 August Boesche 160	18 Philip Balliet 160	17 John Zimbelman 160	17 School Land 480	16 F. & G. Bauer 160	15 G. N. Forsythe 160	15 Henry Diehl 320	15 C. O. Edge 160	14 Henry Diehl 160	14 L. L. Maxwell 160	14 L. Rubin 160	13 CARSON	13 CARSON	13 CARSON	13 CARSON	13 CARSON	TWP
	1 Emil West 80	19 John West 160	20 F. K. Finck 160	21 Carl Piddie 80	21 Fred Heine 152.07	22 Geo. Leitch 160	22 H. H. M. Cue 160	22 Martin Heine 320	23 Adam Horst 312.89	23 Edwin Broadhead 160	23 Wallace Broadhead 160	24 S. C. Lane 160	24 Delia Carter 158.54	24 Delia Carter 158.54	24 Delia Carter 158.54	TWP	
	3 Henry Lauo 240	20 Fredrick Finck 156.30	20 Ludwig Henke 40	21 Ludwig Henke 141.64	21 J. H. Zimbelman 160	22 R. A. Perkins 160	23 Wm. Schmeding 160	23 Wm. Schmeding 160	23 Wm. Schmeding 160	24 S. C. Lane 160	24 Delia Carter 158.54	24 Delia Carter 158.54	24 Delia Carter 158.54	24 Delia Carter 158.54	24 Delia Carter 158.54	TWP	
	1 Geo. Mantel 80	30 N. C. Erach 80	29 R. Durksen 314.92	29 Fred Debing 320	28 Elmer Larson 160	28 C. A. Missmar 80	28 R. C. Richmond 80	27 G. Zimbelman 80	27 Gold Stayback 160	26 Wm. Schmeding 160	26 J. W. Evans 320	25 Delia Carter 160	25 H. W. Fulback 160	25 Charles Honey 160	25 H. W. Fulback 160	TWP	
	3 Simon Pederson 80	30 N. C. Erach 80	29 R. Durksen 314.92	29 Fred Debing 320	28 Elmer Larson 160	28 C. A. Missmar 80	28 R. C. Richmond 80	27 G. Zimbelman 80	27 Gold Stayback 160	26 Wm. Schmeding 160	26 J. W. Evans 320	25 Delia Carter 160	25 H. W. Fulback 160	25 Charles Honey 160	25 H. W. Fulback 160	TWP	
	3 Geo. Mantel 80	31 Hillcrest Stock Farm 160	32 Claude Lackey 160	32 Claude Lackey 160	33 Claude Lackey 160	33 Claude Lackey 160	33 Claude Lackey 160	34 David Petersen 160	34 Alb. Lah 160	35 Geo. Broadhead 160	35 J. W. Evans 160	36 School Land 320	36 School Land 320	36 School Land 320	36 School Land 320	TWP	
ELM	3 Aug F. Stock 80	31 Aug F. Stock 160	32 Helen Dailey 160	32 Alice M. Emch 160	33 Eva Richmond 160	33 Roy Emch 160	33 S. J. Maurer 320	34 David Petersen 160	34 Alb. Lah 160	35 Geo. Broadhead 160	35 J. W. Evans 160	36 School Land 320	36 School Land 320	36 School Land 320	36 School Land 320	THAIN	

VALLEY VIEW

TWP.

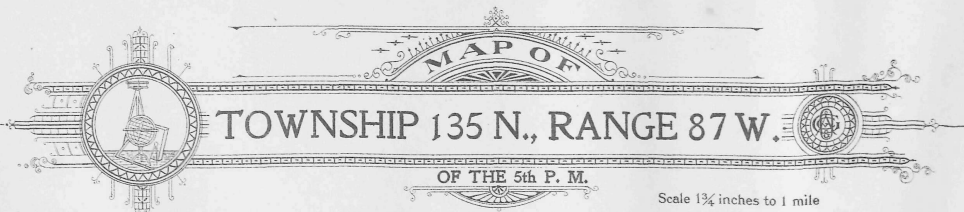

MAP OF
TOWNSHIP 135 N., RANGE 87 W.
OF THE 5th P. M.
 Scale 1 1/4 inches to 1 mile

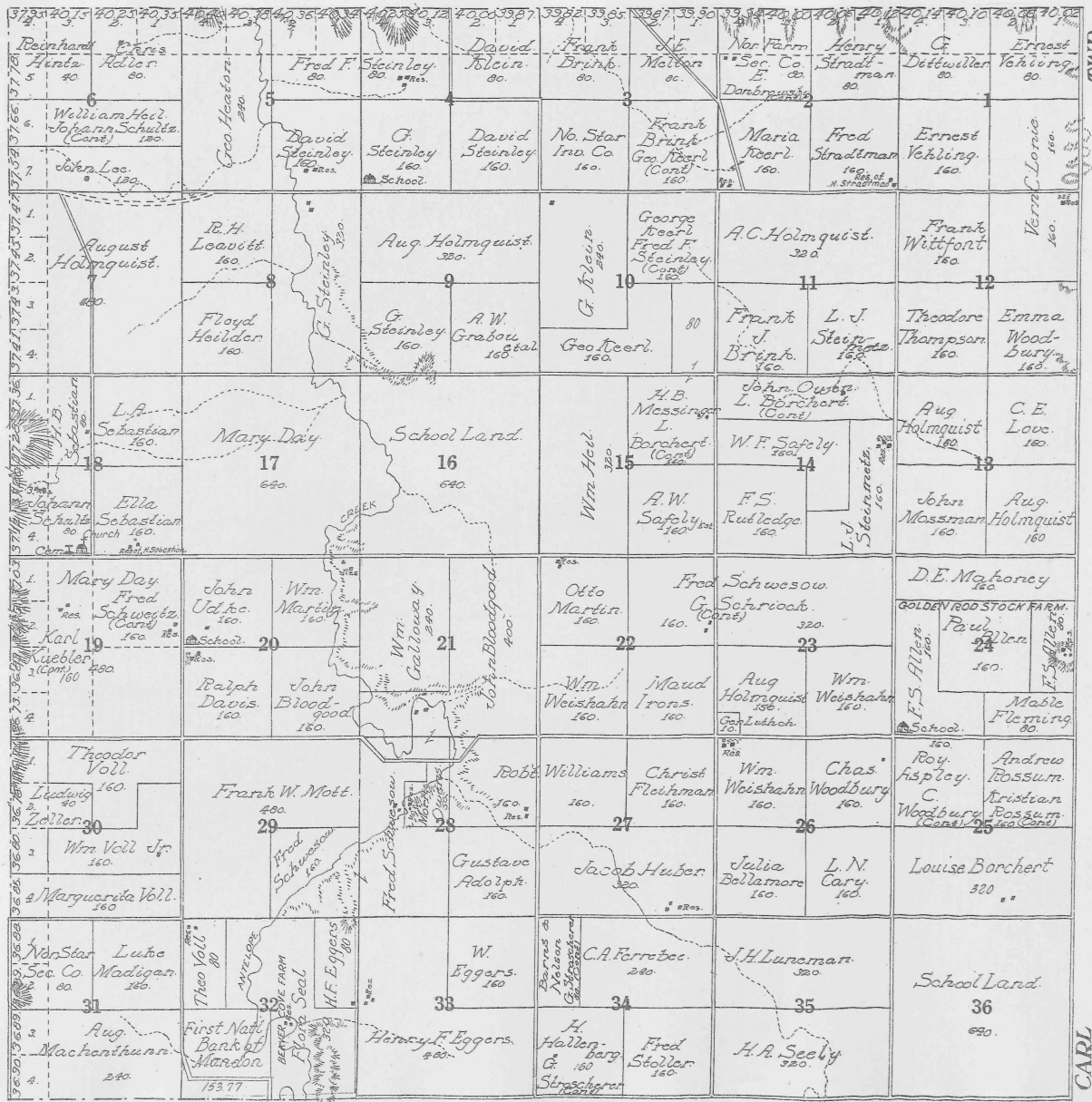

CARSON

TWP.

TWP.

CARL

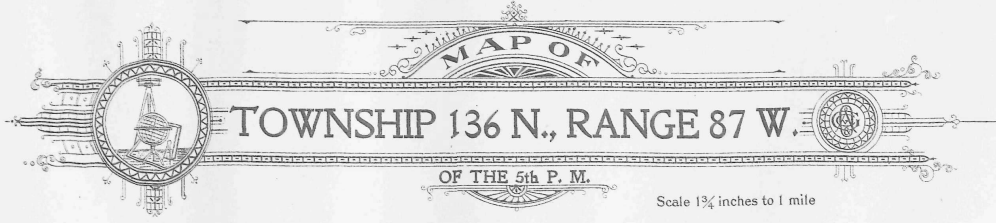

MAP OF
TOWNSHIP 136 N., RANGE 87 W.
OF THE 5th P. M.
 Scale 1 1/4 inches to 1 mile

MORTON

CO.

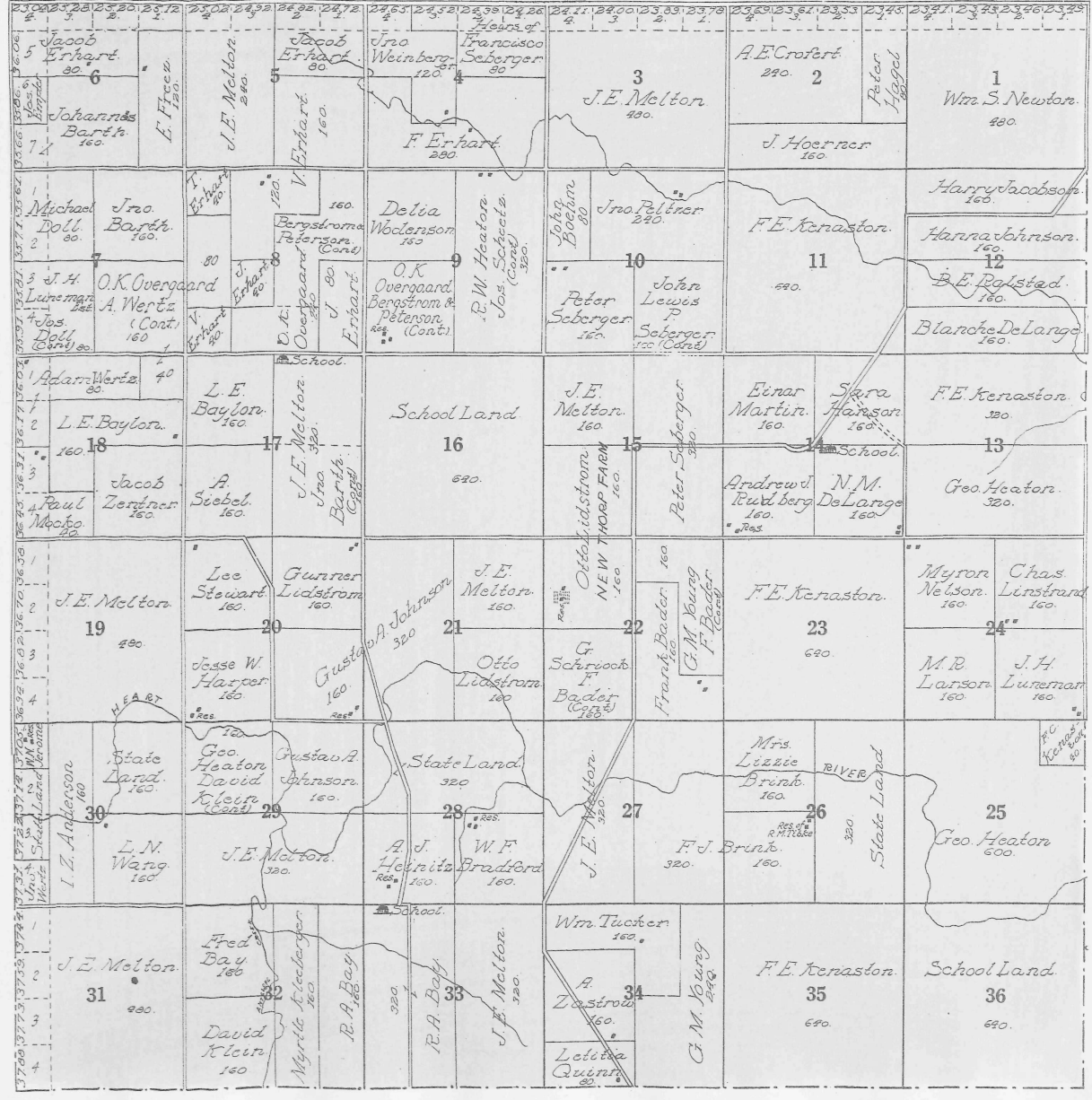

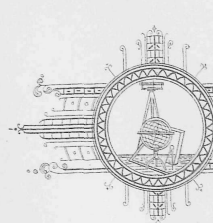

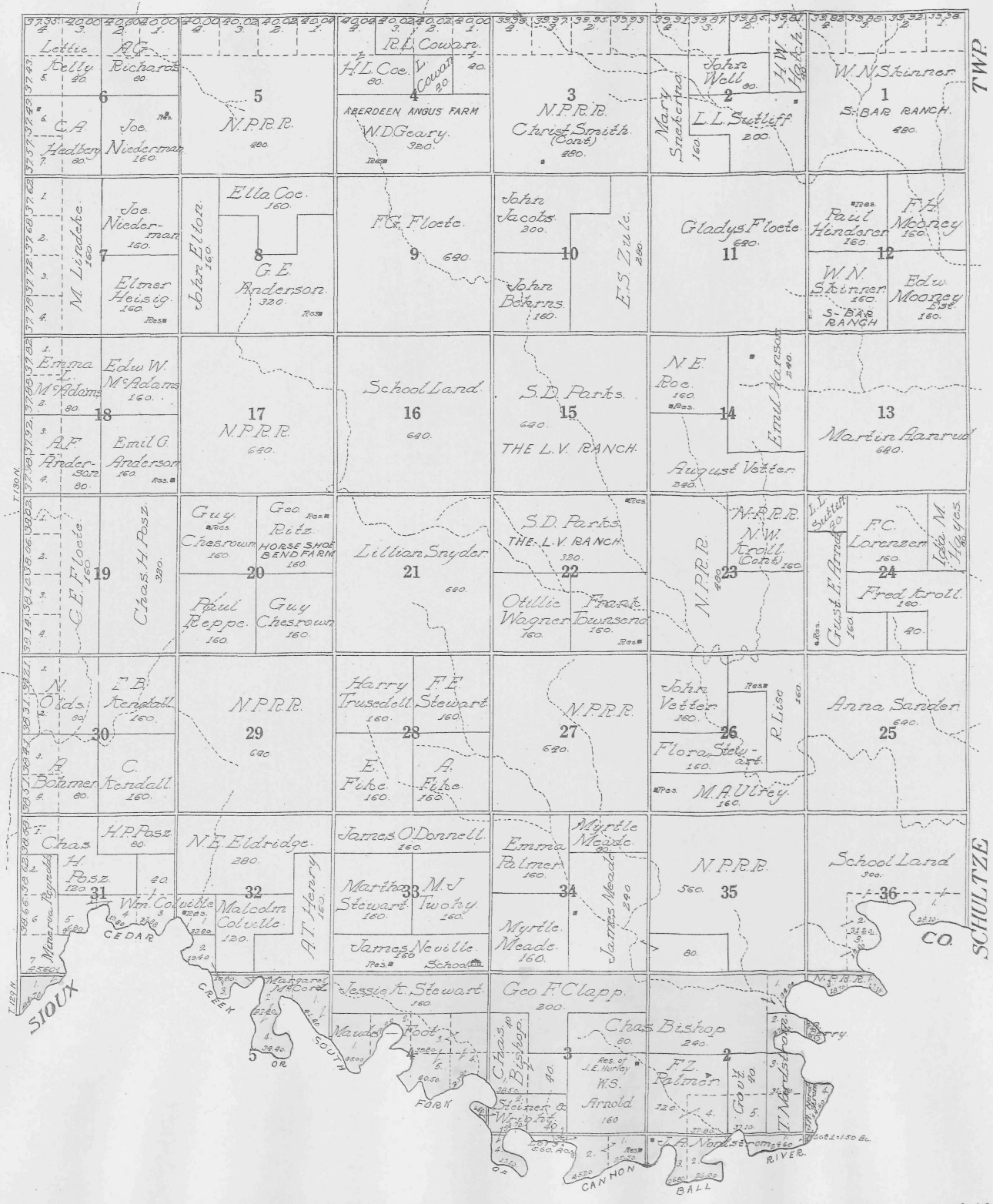
MAP OF
Part of Townships 129 and 130 N., Range 88 W.
 OF THE 5th P. M.
 Scale 1 1/4 inches to 1 mile

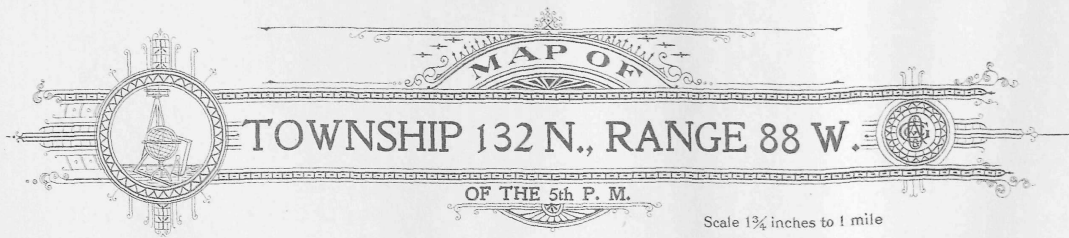

TWP.

SCHULTZE CO.



MAP OF

TOWNSHIP 132 N., RANGE 88 W.

OF THE 5th P. M.

Scale 1 1/4 inches to 1 mile

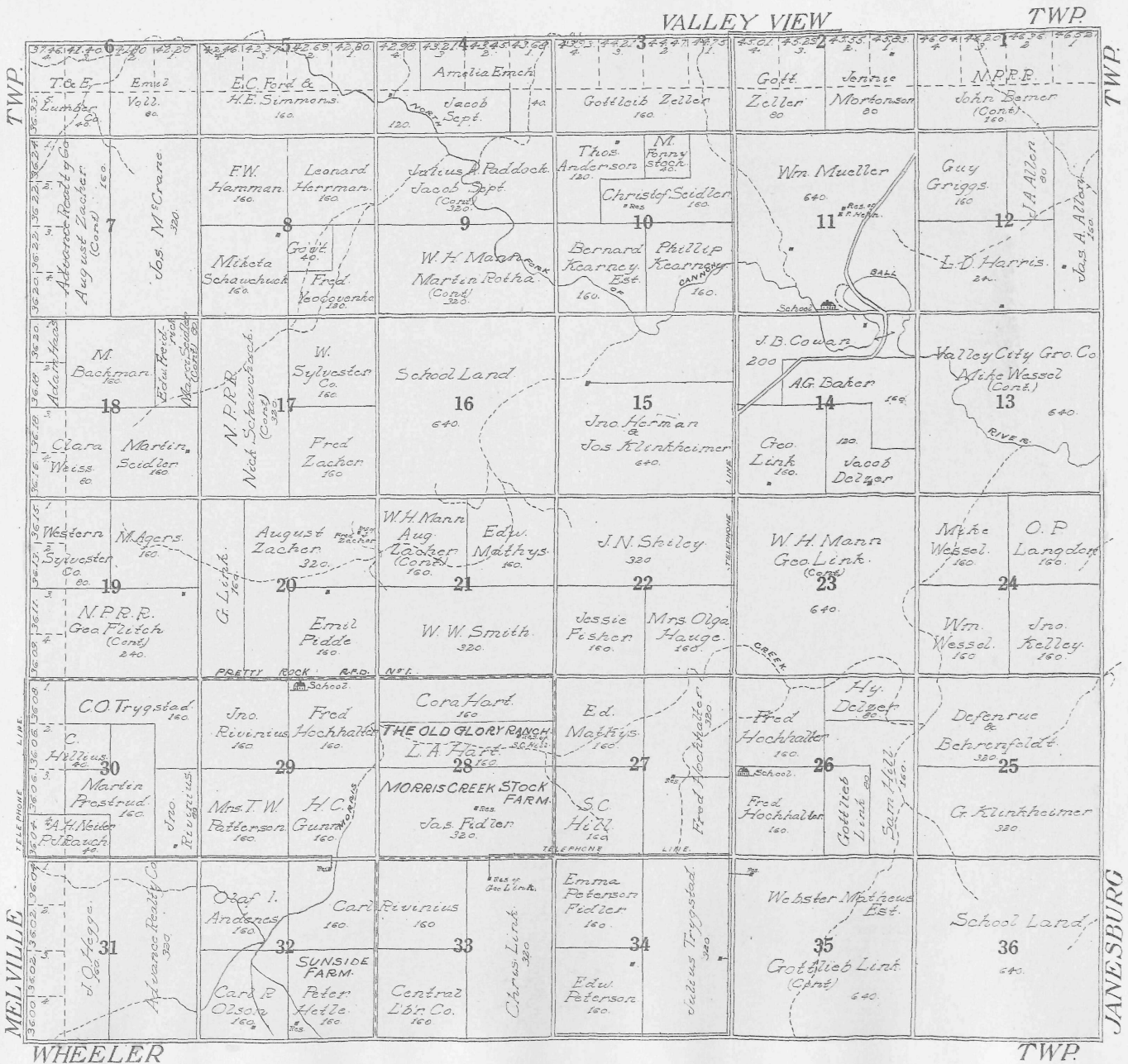

MAP OF
TOWNSHIP 133 N., RANGE 88 W.
 OF THE 5th P. M.

Scale 1 3/4 inches to 1 mile

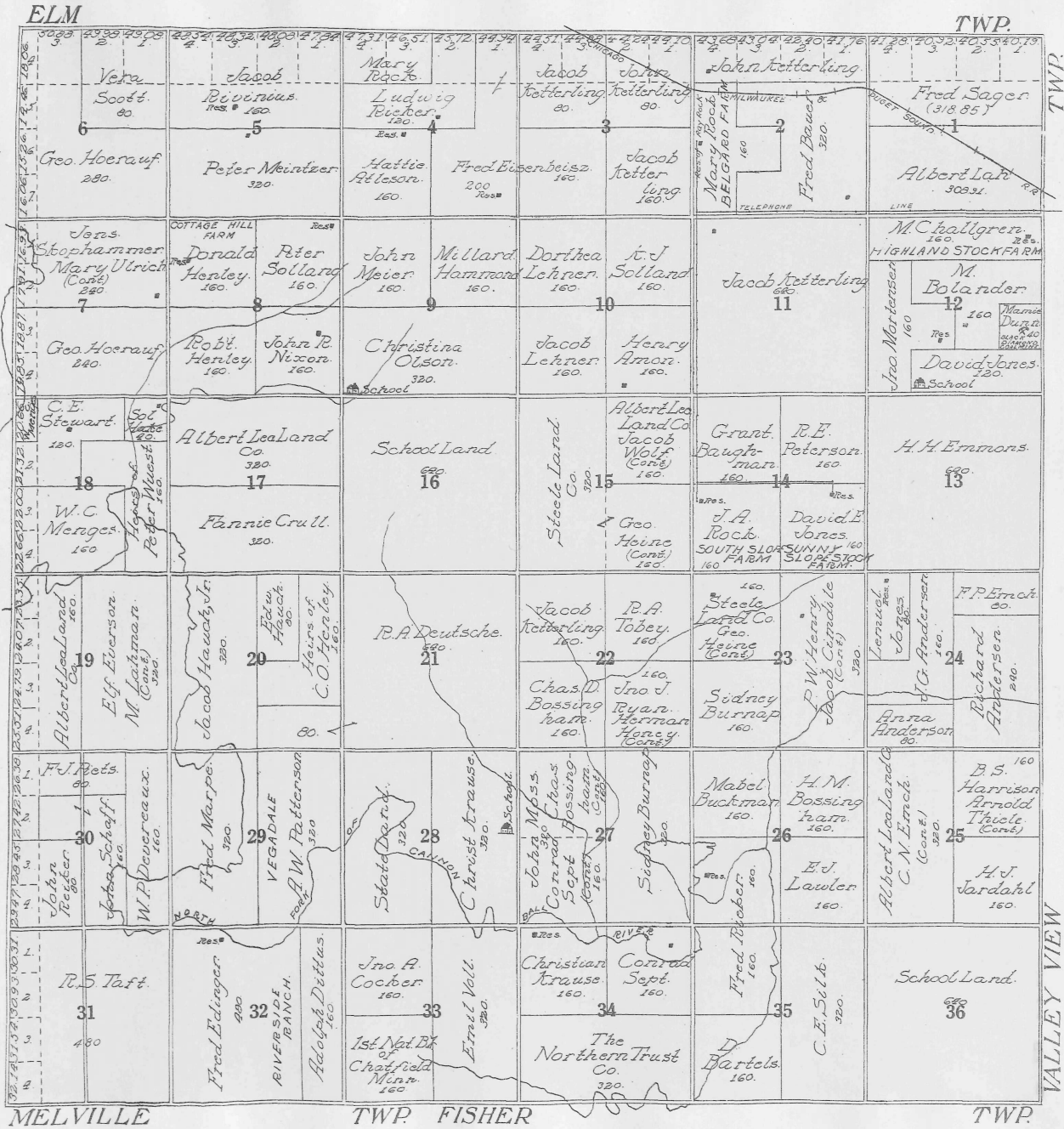

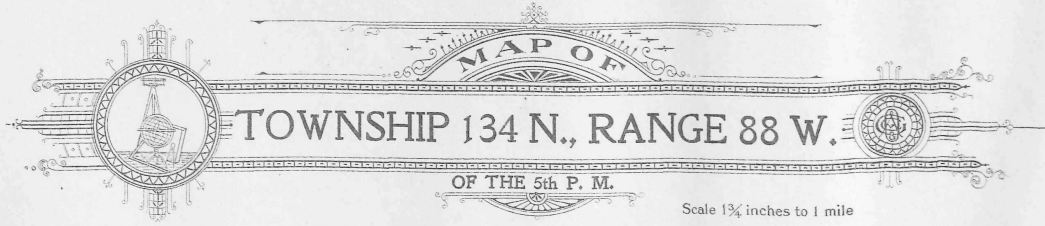

MAP OF

TOWNSHIP 134 N., RANGE 88 W.

 OF THE 5th P. M.

Scale 1/4 inches to 1 mile

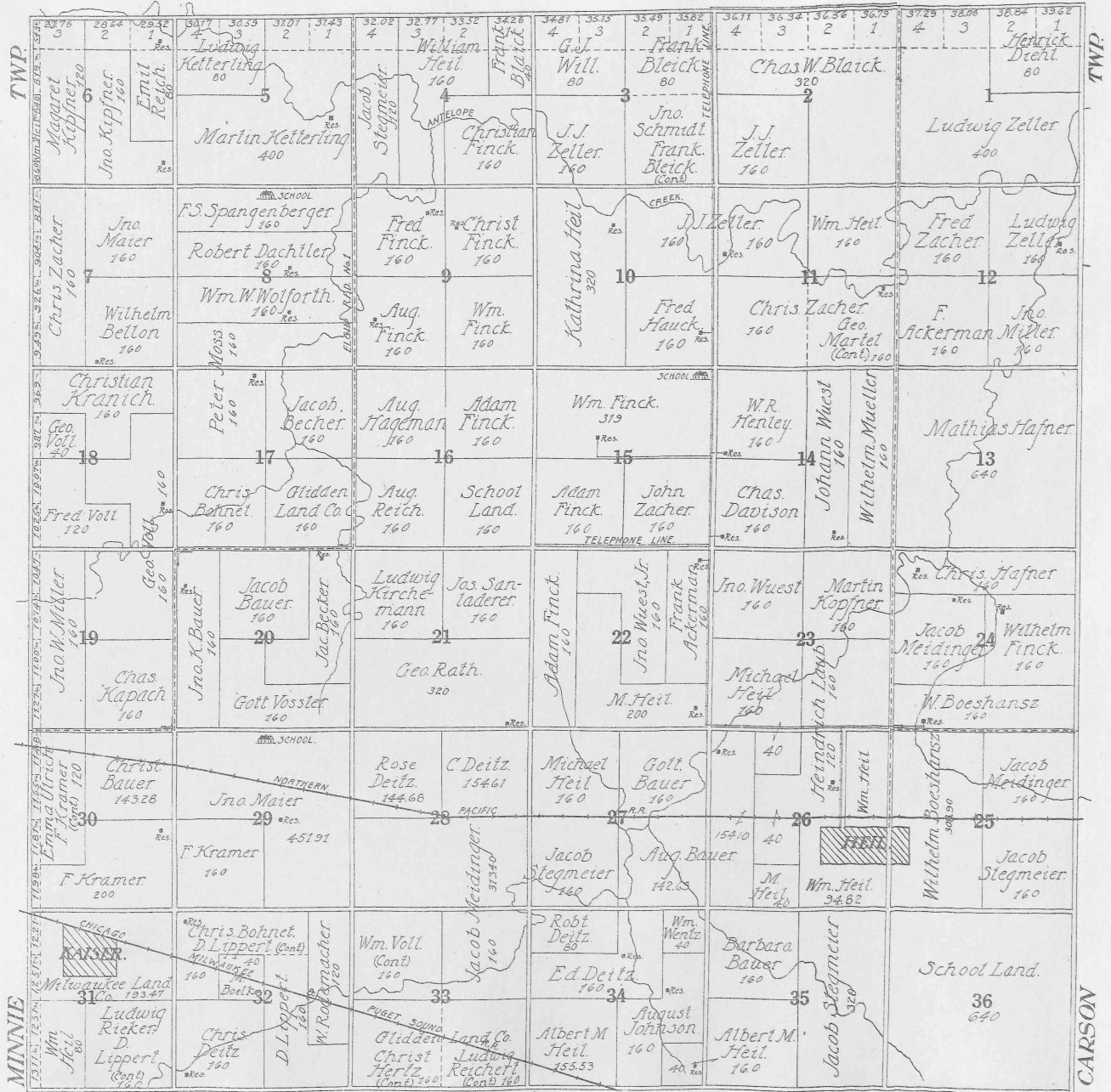

MAP OF

TOWNSHIP 135 N., RANGE 88 W.

 OF THE 5th P. M.

Scale 1 3/4 inches to 1 mile

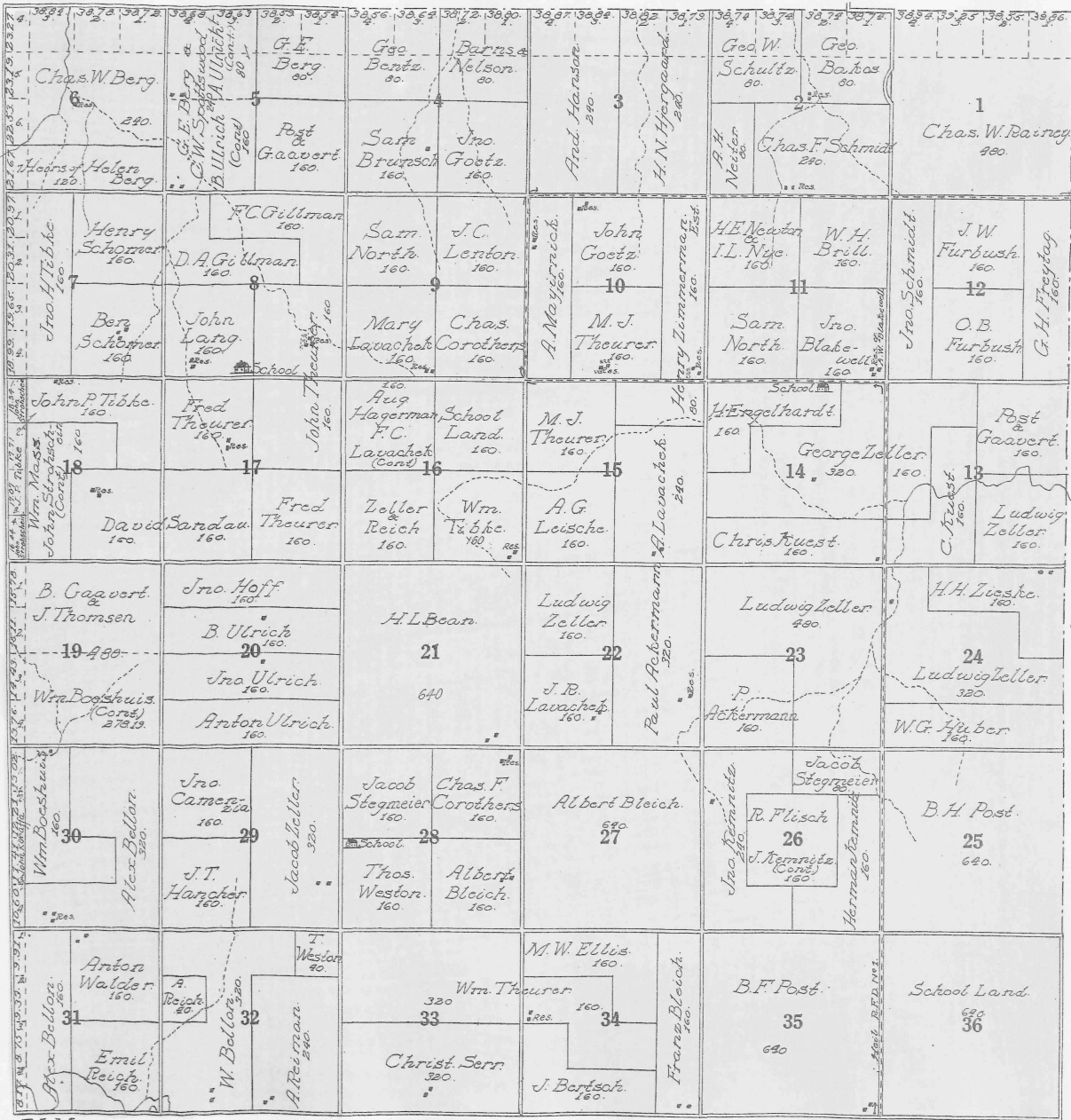

ELM

TWP.

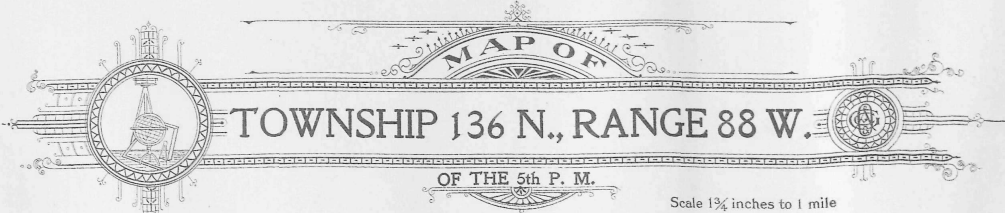

MAP OF
TOWNSHIP 136 N., RANGE 88 W.
OF THE 5th P. M.
 Scale 1 3/4 inches to 1 mile

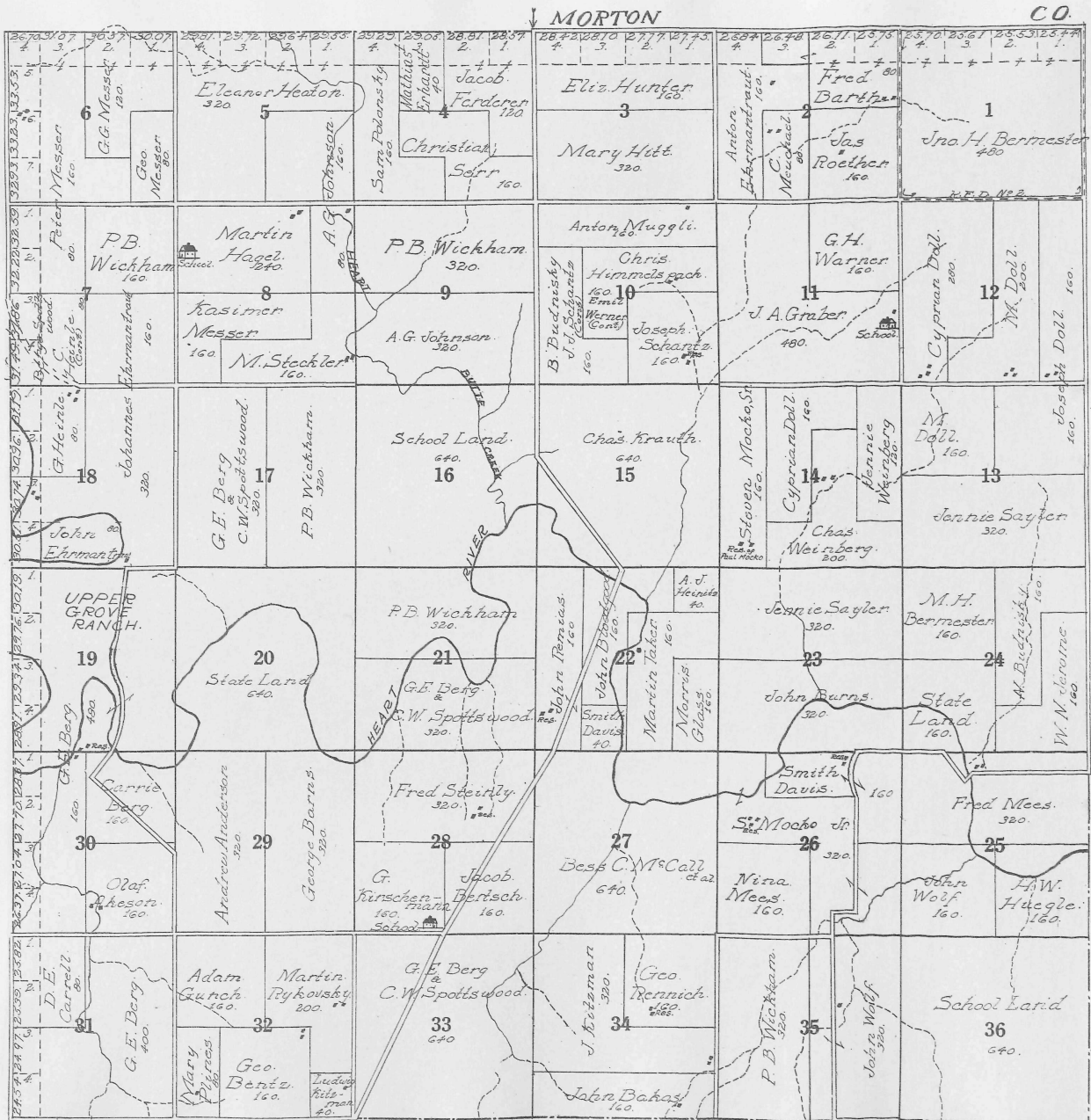

MAP OF
TOWNSHIP 137 N., RANGE 88 W.
OF THE 5th P. M.
 Scale 1 1/4 inches to 1 mile

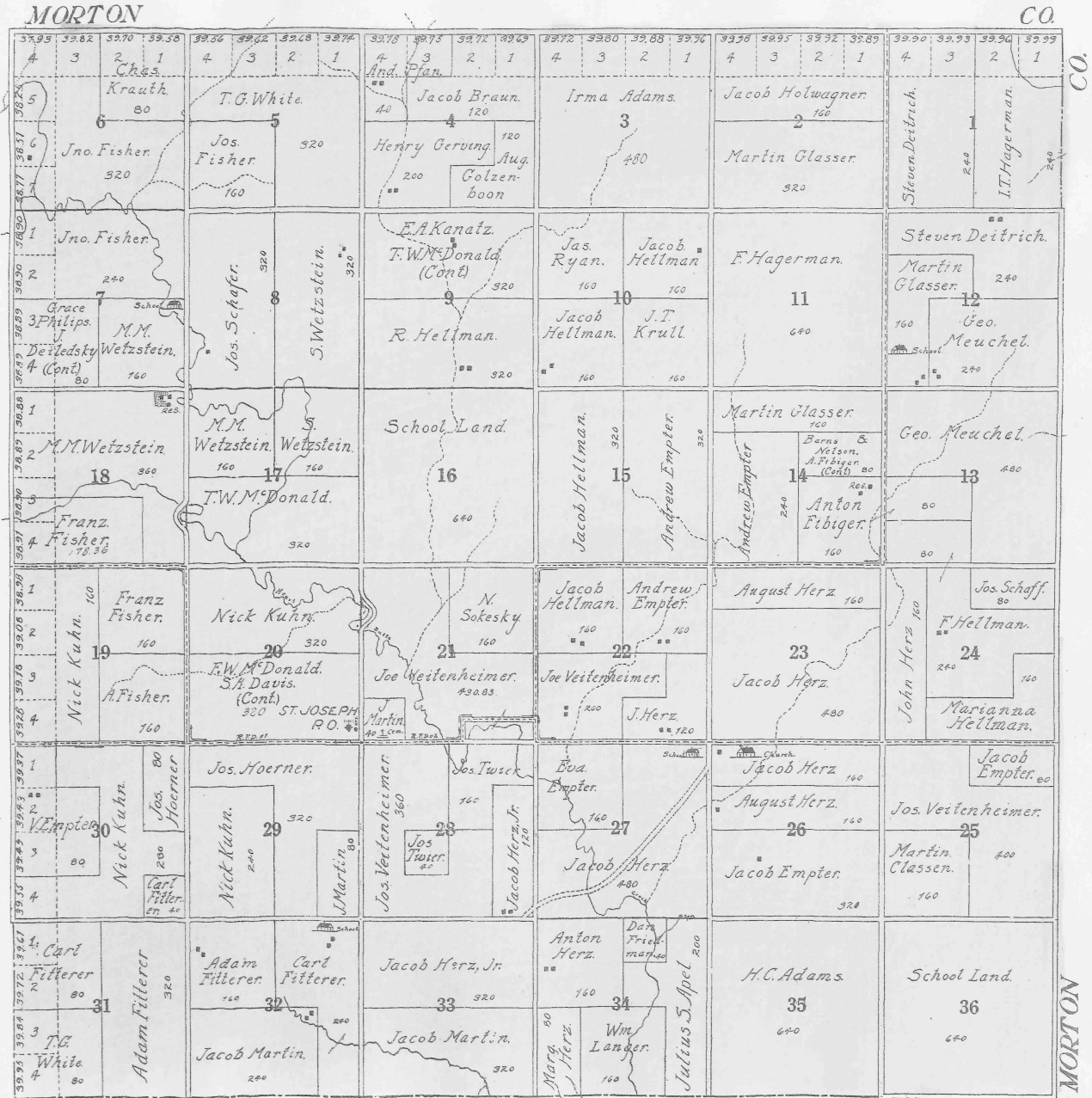

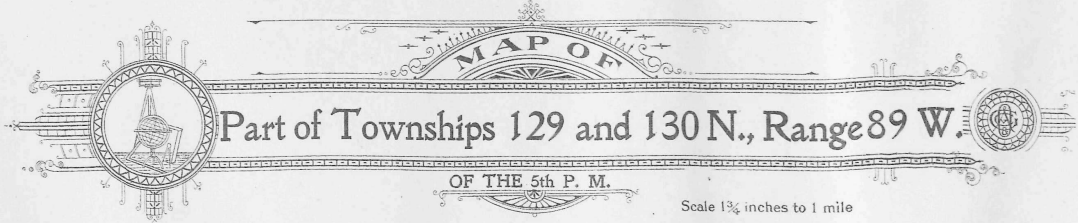

MAP OF
Part of Townships 129 and 130 N., Range 89 W.
OF THE 5th P. M.
 Scale 1 1/2 inches to 1 mile

PRETTY ROCK

TWP.



MAP OF

TOWNSHIP 131 N., RANGE 89 W.

 OF THE 5th P. M.

Scale 1 1/4 inches to 1 mile

MELVILLE										TWP									
TWP										TWP									
4006, 4070, 4014, 4012, 4010, 4008, 4006, 4002, 4000, 3998, 3996, 3994, 3992, 3990, 4001, 4004, 4010, 4014, 4010, 4008, 4002										TWP									
Gott March Heirs, AE Miller, Delta Parr, Wm. Ogilvie, Ingeborg Rafjeseth, Fred Mehl, Marcus Schurer, Fred Mehl, Geo. W. Snook, Geo. W. Snook, N.P.R.R., Fred Gintler										TWP									
1, 2, 3, 4, 5, 6, 7, 8, 9, 10, 11, 12, 13, 14, 15, 16, 17, 18, 19, 20, 21, 22, 23, 24, 25, 26, 27, 28, 29, 30, 31, 32, 33, 34, 35, 36										TWP									
J.McGinnis & DW Zinn, John C. Neuman, Gladys Floete, N. Hueltt, Irving Hueltt, I Hueltt, Chas. Stoller, N.P.R.R., AJ Wilhelm, Fred Gintler, Chas. G. Jones, Joseph Jones, K. Hueltt, I Hueltt, Sebastian Pflutzer, John Schmitz, CE Floete, R.C. & Jennie Breckenridge, K. Hueltt, Irving Hueltt, Frank Schmitz, F.G. Floete, Russel Parr, Geo. P. Skoglund, Chas. Kavaney, L.C. Sander, Hattie Aldrich, John Merrick, Albert Hegge, W.F. Mann, D. Klein, Chas. Wattin, Chas. Babcox, Cora Campbell, Leroy Beebe, Albert Parr, Merchant State Bank, Gien Ullin, DP Barnes, Martin Peterson, Daniel Zinn, Chas. Moore, Chas. Stoller, Wm. Heil, Grace Campbell, CE Floete, John Merrick, E.M. Hegge, Albert Parr, Chas. Moore, Frank Schmitz, F.C. Campbell, W.W. Snyder, Kate Cordley, Albert Hegge, William M. Snyder, Z.H. Ravn, A.O. Zinn, Philip Schall, Advance Realty Co., School Land, W.S. Schoonmaker, Andrew C. Anderson, E.C. Cordley, V. Croninger, K.O. O'Leary										TWP									
KREUTZ										WHEELER									